

CERTIFIED LAND CORNER RESTORATION

34-12

Index No. E-13

State of Wisconsin }  
County of Langlade } ss.

I, Raymond J. Hallisy, do hereby certify that on the 27th day of July, 1968, I found evidence of the Section corner of 4, 3, 9, & 10 Township 34, North, Range 12, Fourth Principal Meridian, as described hereon; and that from this evidence I established a new monument and accessories as described hereon to perpetuate the original location of this corner.

Resident witnesses:  
.....  
.....  
.....

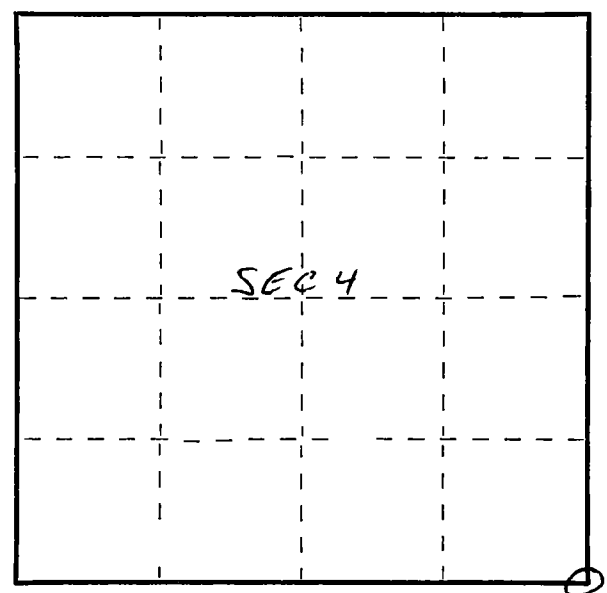

○ = Corner monument restored.

History of original corner establishment:

Corner set in the 1930's by: C. W. Borth

Description of corner evidence found:

Found 6" squared post marked 4 3 9 10  
Old BT Pine stump 18 S72W 46 3/4 lks

Description of monument and accessories I established to perpetuate the original location of this corner.

Set Brass Cap in cement 3' deep 4" thick, 1 1/2' above ground

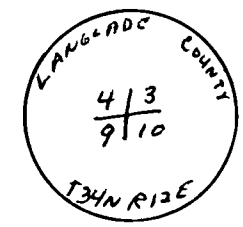
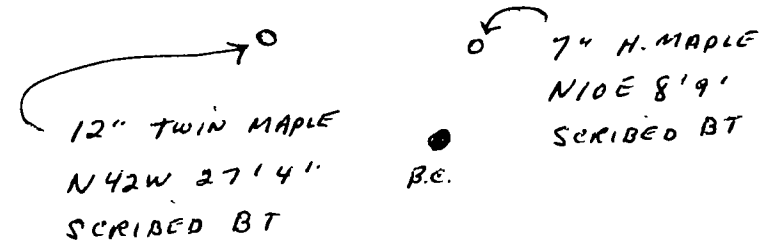

Dated at Antigo, Wis., this 27th day of July, 1968

Signature Raymond J. Hallisy Title Reg. Land Surveyor Registration No. S-685  
(County Surveyor, Registered Land Surveyor, or other duly authorized official)

Office of Register of Deeds, County of \_\_\_\_\_, I hereby certify that the within instrument was filed in this office for record on the \_\_\_\_\_ day of \_\_\_\_\_, 19\_\_\_\_ at \_\_\_\_\_ o'clock \_\_\_\_\_ M.

.....  
(Register of Deeds)

By..... Deputy

FORM 985 H. C. MILLER CO., MILWAUKEE