

CERTIFIED LAND CORNER RESTORATION

Index No. E-15

State of Wisconsin }  
County of Lanquade } ss.

I Raymond Hallisy, do hereby certify that on the 2nd day of MAY, 1987, I found evidence of the 1/4 COR corner of Bet section 3 + 10 Township 34, North, Range 12 E, Fourth Principal Meridian, as described hereon; and that from this evidence I established a new monument and accessories as described hereon to perpetuate the original location of this corner.

Resident witnesses:

.....  
.....  
.....

History of original corner establishment:

ESTABLISHED by A County Surveyor  
IN A Early 1900 RESURVEY.

BAKER FB 149-62 "STONE SET BY BROOKS" 3/20/97 D.T.

Description of corner evidence found:

Rock with + on for 1/4 COR AS MENTIONED  
IN old Survey Notes  
OLD BT Pine stub 33' 5"

Description of monument and accessories I established to perpetuate the original location of this corner.

Set 3" Aluminum pipe with cap  
New BT,S  
Service Berry 4" S10E 31' 5"  
Twin OAK 12" N 86W 45' 10"

Aspen clear cut No other TREES  
Available for BT,S

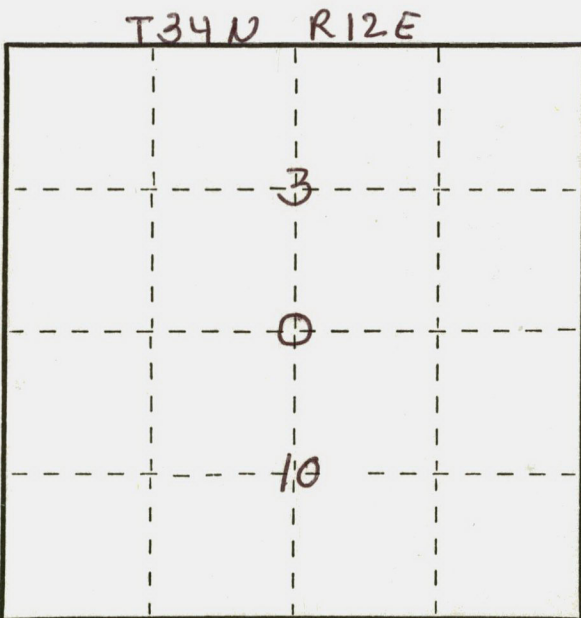
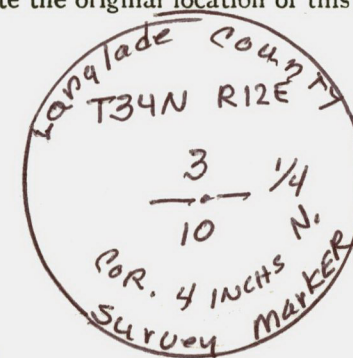

○ = Corner monument restored.

Dated at Antigo, Wis., this 2nd day of MAY, 1987.

Signature Raymond Hallisy Title Land Surveyor Registration No. 5-685  
(County Surveyor, Registered Land Surveyor, or other duly authorized official)

Office of Register of Deeds, County of ....., I hereby certify that the within instrument was filed in this office for record on the ..... day of ....., 19..... at ..... o'clock ..... M.

.....  
(Register of Deeds)

By ..... Deputy