

CERTIFIED LAND CORNER RESTORATION

Index No. E-17

State of Wisconsin }
County of LANGLADE } ss.

I William F. Kelly, do hereby certify that on the 11th day of SEPT, 1979, I found evidence of the NORTH WEST corner of SECT 11 Township 34, North, Range 12 EAST, Fourth Principal Meridian, as described hereon; and that from this evidence I established a new monument and accessories as described hereon to perpetuate the original location of this corner.

Resident witnesses:

Lawrence W. Krater

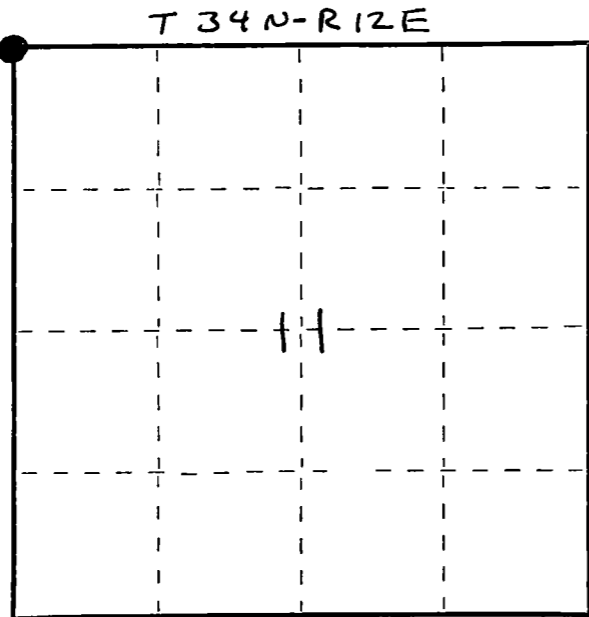

○ = Corner monument restored.

History of original corner establishment:

Description of corner evidence found:
LOCATED REMAINS OF SCRIBED 4x4 POST
SET NEW 2"x42" I.P. WITH GRASS CAP AND
SET 4x4 CEDAR POSTS next to GRASS CAP.

NOTE: CORNER LOCATED IN A WET AREA



Description of monument and accessories I established to perpetuate the original location of this corner.

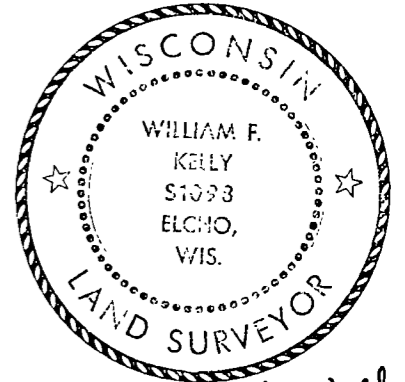
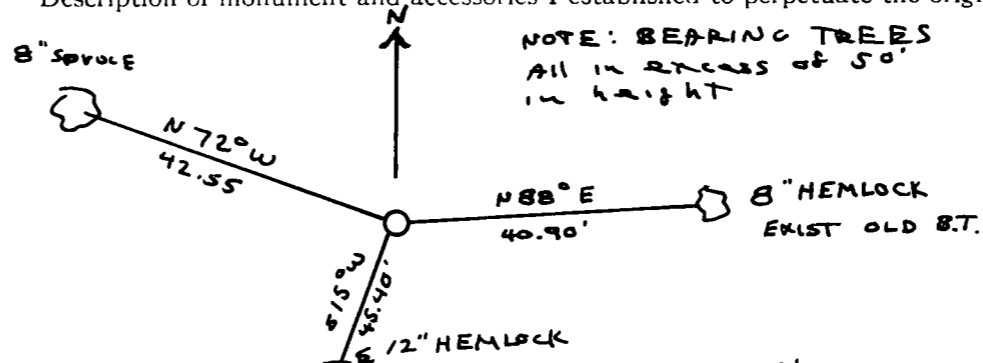

William F. Kelly



Dated at ECCHO, Wis., this 11th day of SEPT., 1979

Signature William F. Kelly Title County Surveyor Registration No. 5-1098
(County Surveyor, Registered Land Surveyor, or other duly authorized official)

Office of Register of Deeds, County of _____, I hereby certify that the within instrument was filed in this office for record on the _____ day of _____, 19____ at _____ o'clock _____ M.

(Register of Deeds)

By _____ Deputy