

CERTIFIED LAND CORNER RESTORATION

34-11
Index No. Y-13

State of Wisconsin }
County of LANGLADE } ss.

I, RAYMOND J. HALLISY, do hereby certify that on the 19TH day of MAY, 19 73, I found evidence of the SOUTH 1/16 corner of SECTION 33 & 34 Township 34, North, Range 11 EAST, Fourth Principal Meridian, as described hereon; and that from this evidence I established a new monument and accessories as described hereon to perpetuate the original location of this corner.

History of original corner establishment:
SET BY CHARLES BORTH
IN RESURVEY IN 1934

Description of corner evidence found:
SCRIBED STAKE, IN ROCK MOUND
WCD LOCATION POSTER N80°E 13.6 FT

Resident witnesses:

.....
.....
.....

Description of monument and accessories I established to perpetuate the original location of this corner.

2" IRON PIPE, WITH BRASS CAP
ROCK MOUND
NEW B.T.s
HEMLOCK 4" N60°E 11 FT. 2" INCHS
RED MAPLE 6" S11°E 7 FT. 8 INCHS

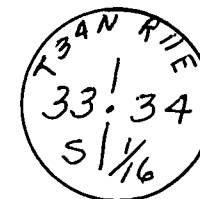

FORM 985 H. C. MILLER CO., MILWAUKEE

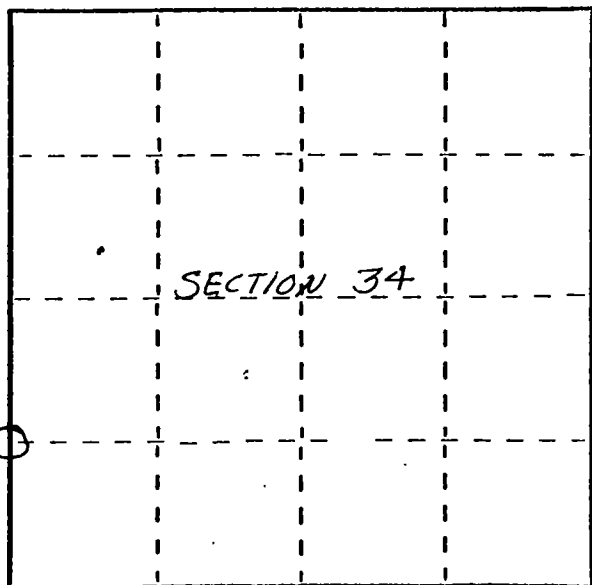

○ = Corner monument restored.

Dated at ANTIGO, Wis., this 19TH day of MAY, 19 73

Signature Raymond J. Hallisy Title Reg. Land Surveyor Registration No. 5-685
(County Surveyor, Registered Land Surveyor, or other duly authorized official)

Office of Register of Deeds, County of _____, I hereby certify that the within instrument was filed in this office for record on the _____ day of _____, 19 _____ at _____ o'clock _____ M.

.....
(Register of Deeds)

By..... Deputy