

CERTIFIED LAND CORNER RESTORATION

Index No. ~~X-38~~ 2

State of Wisconsin }
County of Langlade } ss.

I Philip T. Hansen, do hereby certify that on the 16th day of September, 1977, I found established ~~corner~~ of the WC 1/16 corner of Section 31 Township 34 North, Range 11 East, Fourth Principal Meridian, as described hereon; and that from this evidence I established a new monument and accessories as described hereon to perpetuate the original location of this corner.

Resident witnesses:

Glen Barker

Jim Claflin

Herb Wagoner

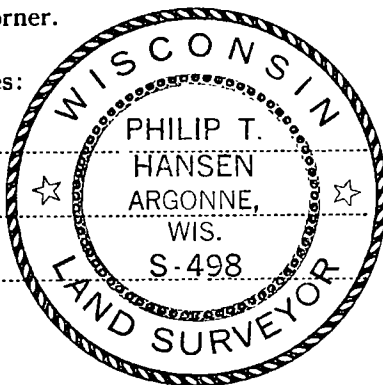

T34N R11E

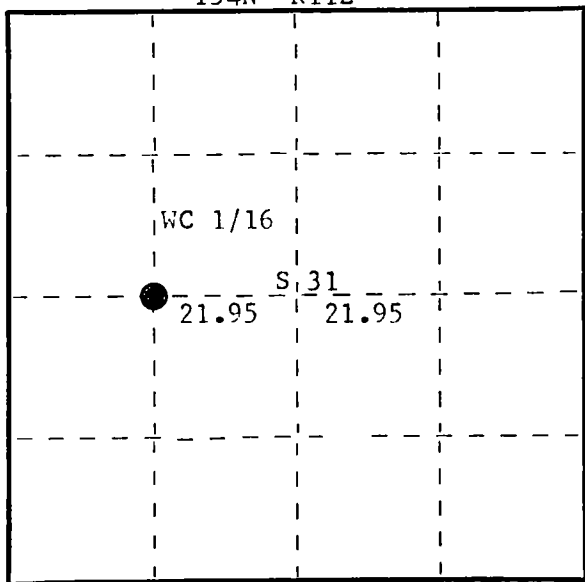

○ = Corner monument restored.

History of original corner establishment:

No records of any previous survey.

Description of corner evidence found:

No evidence of any corner recovered.

Established corner by running traverse from C 1/4 corner to recovered EC 1/16 corner.

Computed distance 21.59 chains at bearing N 87° 56' 45" E.

Ran true line S 87° 56' 45" W a distance of 21.59 chains and set WC 1/16 corner.

Description of monument and accessories I established to perpetuate the original location of this corner.

Set 2" iron pipe with brass cap projecting 18" above ground, cap stamped:

Marked NBTs - Sugar 10" N20°E, 51.2 links, scribed 1/16 BT.

Sugar 6" S64°E, 16.8 links, scribed 1/16 BT.

T34N R11E

WC 1/16 S 31

S498-1977

Dated at Rhinelander, Wis., this 21st day of September, 1977.

Signature: *Philip T. Hansen* Title Registered Land Surveyor Registration No. S-498
(County Surveyor, Registered Land Surveyor, or other duly authorized official)

Office of Register of Deeds, County of Langlade, I hereby certify that the within instrument was filed in this office for record on the _____ day of _____, 19____ at _____ o'clock _____ M.

(Register of Deeds)

By _____ Deputy

FORM 985 H. C. MILLER CO., MILWAUKEE