

CERTIFIED LAND CORNER RESTORATION

34-11
Index No. X-5

State of Wisconsin }
County of Langlade } ss.

I, Raymond J. Hallisy, do hereby certify that on the 19th day of June, 1971, I found evidence of the 4 corner of Section 31 & 32 Township 34, North, Range 11E, Fourth, Principal Meridian, as described hereon; and that from this evidence I established a new monument and accessories as described hereon to perpetuate the original location of this corner.

History of original corner establishment:

Corner set by C. Borth in the 1930's

Description of corner evidence found:

Found his wood stake and flat iron 1/2" by 3', wood stake in fair condition. BT cedar post N9E 4 Feet. Wood stake marked 31 32

Resident witnesses:

.....
.....
.....

Description of monument and accessories I established to perpetuate the original location of this corner.

Set 2" pipe with brass cap between wood stake and 1/2" by 3 Foot iron.

BT's to corner
4" Tamarack N75E 3 Feet 4 inches
4" Spruce N37W 13 Feet 4 inches
BT's faced at base of tree and scribed BT

Placed Location Poster about 2 1/2 Chains North on 3" Spruce next to Fire Lane.



FORM 985 H. C. MILLER CO., MILWAUKEE

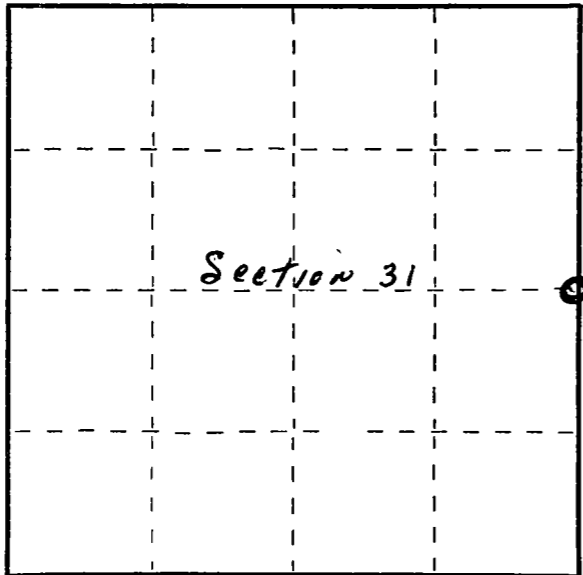

○ = Corner monument restored.

Dated at Antigo, Wis., this 19th day of June, 1971

Signature R. J. Hallisy Title Reg. Land Surveyor Registration No. 5-685
(County Surveyor, Registered Land Surveyor, or other duly authorized official)

Office of Register of Deeds, County of....., I hereby certify that the within instrument was filed in this office for record on the.....day of....., 19..... at.....o'clock..... M.

(Register of Deeds)

By.....Deputy