

CERTIFIED LAND CORNER RESTORATION

Index No. 5-5

State of Wisconsin } ss.
County of Langlade

I Philip T. Hansen, do hereby certify that on the 18th day of February, 1976, I ~~found~~ established the N-1/16 corner of Sections 29 and 30 Township 34 North, Range 11 East, Fourth Principal Meridian, as described hereon; and that from this evidence I established a new monument and accessories as described hereon to perpetuate the original location of this corner.

Resident witnesses:

Glen Barker

Jim Claflin

Herb Wagoner

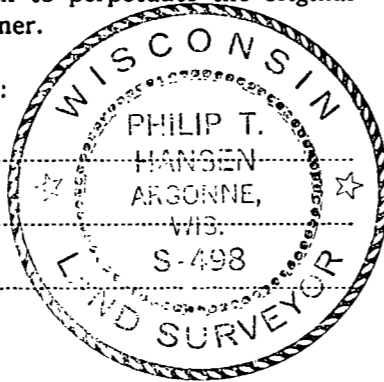

History of original corner establishment:

Re-established this corner from random line run from NE Section Corner to SE corner. See T-5. Set the N-1/16 corner equidistant between NE corner and re-established 1/4 corner, at 19.83 chains, S0°40'E of NE corner, and 0.75 lks. East of random line.

Description of corner evidence found:

Made an intensive search for evidence of the older corner and bearing trees, but was unable to recover any evidence.

Description of monument and accessories I established to perpetuate the original location of this corner.

Set a 2" iron pipe with brass cap for corner monument. Cap stamped -

Pipe projects 12" above ground level.

NBT's - Sugar 8" S54°E 9.6 lks. scribed 1/16 BT

Sugar 10" N33°E 63.8 lks. scribed 1/16 BT

Pipe and BT's painted blue.

S498
T34N, R11E

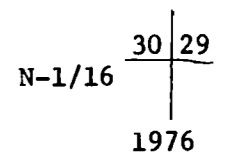

FORM 985 Wisconsin Planning & Surveying Co. Milwaukee, Wisconsin

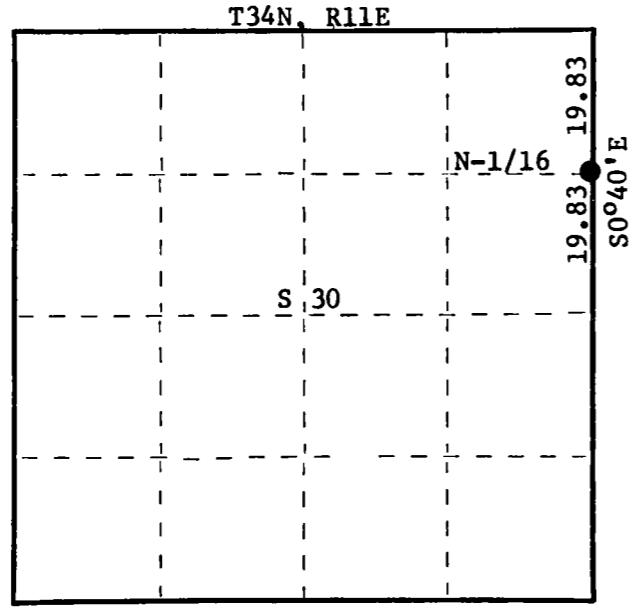

○ = Corner monument restored.

Dated at Rhinelander, Wis., this 24th day of February, 1976

Signature Philip T. Hansen Title Registered Land Surveyor Registration No. S-498
(County Surveyor, Registered Land Surveyor, or other duly authorized official)

Office of Register of Deeds, County of Langlade, I hereby certify that the within instrument was filed in this office for record on the _____ day of _____, 19____ at _____ o'clock _____ M.

(Register of Deeds)

By _____ Deputy JS.