

CERTIFIED LAND CORNER RESTORATION

Index No. T-2

State of Wisconsin } ss.
County of Langlade }

History of original corner establishment:

I Philip T. Hansen, do hereby certify that on the 1st day of March, 1976, I found established evidence of the WC-1/16 corner of Section 30 Township 34 North, Range 11 East, Fourth Principal Meridian, as described hereon; and that from this evidence I established a new monument and accessories as described hereon to perpetuate the original location of this corner.

Description of corner evidence found: Corner established from previously established C-1/4 corner and W-1/4 corner between Section 30-34-11 and Section 25, T34N, R10E. Set corner by proportion, 21.117 chains S88°15'W of C-1/4 corner and 25.269 chains N88°15'E of W-1/4 corner.

Resident witnesses:

Glen Barker
Jim Clafli
Herb Wagone

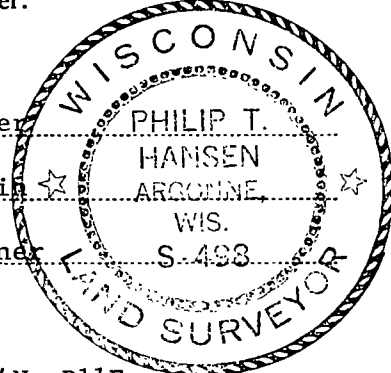

Description of monument and accessories I established to perpetuate the original location of this corner.

Set 2" iron pipe with brass cap stamped -
Pipe projects 18" above the ground.

S498
T34N, R11E

NBT's - Sugar 10" S51°E 48 links scribed 1/16 BT
Sugar 8" N14°W 87 links scribed 1/16 BT

WC-1/16 S 30
1976

Pipe and BT's painted blue.

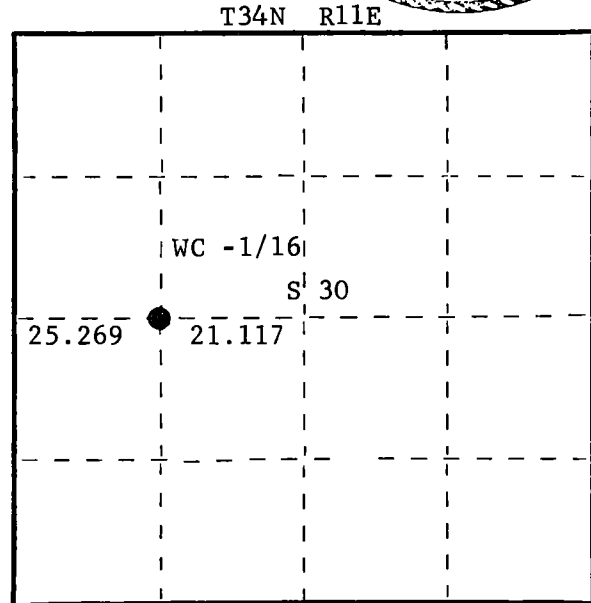

Dated at Rhinelander, Wis., this 4th day of March, 1976.

Signature Philip T. Hansen Title Registered Land Surveyor Registration No. S-498
(County Surveyor, Registered Land Surveyor, or other duly authorized official)

Office of Register of Deeds, County of Langlade, I hereby certify that the within instrument was filed in this office for record on the _____ day of _____, 19____ at _____ o'clock _____ M.

(Register of Deeds)

By _____ Deputy QS

○ = Corner monument restored.

FORM 985 Wisconsin Planning Machinery Co. Milwaukee, Wisconsin