

CERTIFIED LAND CORNER RESTORATION

Index No. T-3

State of Wisconsin }  
 County of Langlade } ss.

I Philip T. Hansen, do hereby certify that on the 24th day of February, 1976, I ~~re-established~~ established ~~the~~ C-1/4 corner of Section 30 Township 34, North, Range 11 East, Fourth Principal Meridian, as described hereon; and that from this evidence I established a new monument and accessories as described hereon to perpetuate the original location of this corner.

Resident witnesses:

Glen Barker

Jim Clafli

Herb Wagone



History of original corner establishment:

Description of corner evidence found: Established center 1/4 corner by running random line South from N-1/4 corner and corrected line. Then, ran E-W-1/4 random line East from W-1/4 corner to East 1/4 and corrected same. Center 1/4 corner measures 39.80 chains S0°24' East of N-1/4 corner and 42.23 chains South 88°15' West of East 1/4 corner.

This corner sets on the North edge of hunting river.

Description of monument and accessories I established to perpetuate the original location of this corner.

Drove a 1-1/2" x 6' iron pipe for the true corner. Pipe projects 8" above ground. Set a 2-1/2" iron pipe with brass cap 90 links north of true corner for a witness corner. Pipe projects 1' above ground. Cap stamped -

S498  
 T34N, R11E  
 C-1/4  $\frac{S}{30}$  WC  
 90 links S.  
 CPI - 1976

NBT - White pine 14" S2°E 2.48 chains scribed C-1/4 BT  
 1-1/2" iron pipe with brass cap, N20°W, 120 links stamped -  $\frac{W}{S20^{\circ}E} \frac{C}{120 \text{ links}}$

1-1/2" iron pipe with brass cap, N76°E, 110 links stamped -  $\frac{W}{S76^{\circ}W} \frac{C}{110 \text{ links}}$   
 W.M.'s project 2' above ground. Measurements made from true corner. Pipe, W.M., and BT painted blue.

Dated at Rhineland, Wis., this 4th day of March, 1976.

Signature Philip T. Hansen Title Registered Land Surveyor Registration No. S-498  
 (County Surveyor, Registered Land Surveyor, or other duly authorized official)

Office of Register of Deeds, County of Langlade, I hereby certify that the within instrument was filed in this office for record on the \_\_\_\_\_ day of \_\_\_\_\_, 19\_\_\_\_ at \_\_\_\_\_ o'clock \_\_\_\_\_ M.

(Register of Deeds)

By \_\_\_\_\_ Deputy SS

FORM 985 Wisconsin Printing Machinery Co. Milwaukee, Wisconsin

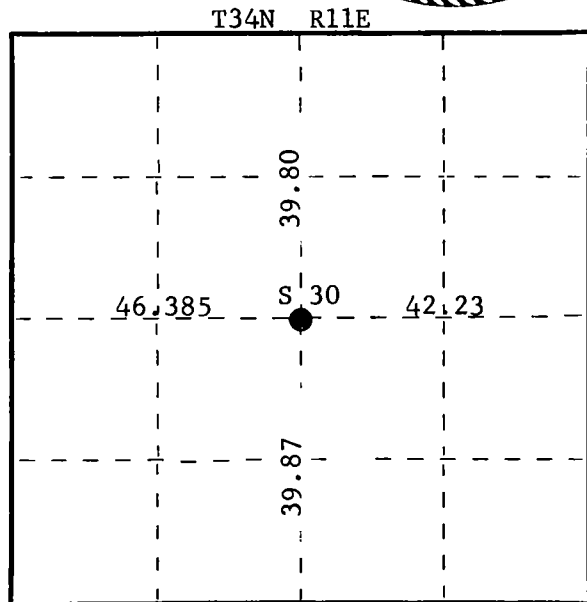

○ = Corner monument restored.