

CERTIFIED LAND CORNER RESTORATION

Index No. T5

State of Wisconsin }  
County of Langlade } ss.

I Philip T. Hansen, do hereby certify that on the 9th day of February, 1976, I ~~re-established~~ established the Quarter corner of Sections 29 and 30 Township 34, North, Range 11 East, Fourth Principal Meridian, as described hereon; and that from this evidence I established a new monument and accessories as described hereon to perpetuate the original location of this corner.

Resident witnesses:

Glen Barker

Jim Claflin

Herb Wagoner

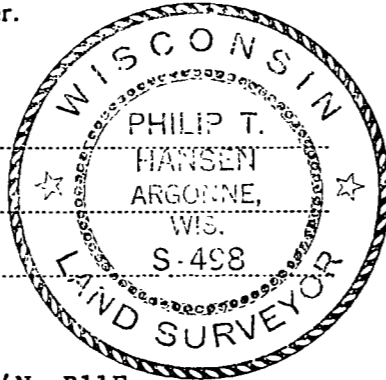

T34N, R11E

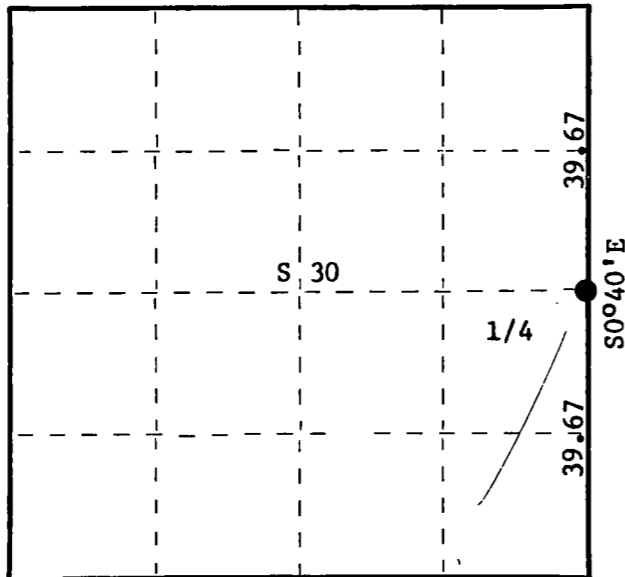

○ = Corner monument restored.

History of original corner establishment:

From Section Corner, Sections 19, 20, 29, and 30, ran random line S1°30'W a distance of 79.605 chains to intersect the South line at a point 2.99 chains West of SE Section Corner. Computed difference in bearing 2°10'. Corrected bearing S0°40'E. Corrected distance to Section Corner 79.34 chains. Correction per chain .03766. Set 1/4 corner equidistant between NE and SE Section Corner at 39.67 chains. 1.49 chains East of right angles.

Description of corner evidence found:

Made an extensive search for evidence of old corner and bearing trees but was unable to recover any evidence.

Description of monument and accessories I established to perpetuate the original location of this corner.

Set a 2-1/2" iron pipe with brass cap for corner monument. Cap stamped -  
Pipe projects 1' above ground level.

NBT's - Red pine 18" N1°W 172.3 lks. scribed 1/4 BT  
W. pine 16" S63°E 182.3 lks. scribed 1/4 BT  
B. spruce 6" S35°W 112.2 lks. scribed 1/4 BT

Pipe and BT's painted blue.

S498  
T34N, R11E  
30 | 29  
1/4 |  
1976

Dated at Rhineland, Wis., this 24th day of February, 1976

Signature Philip T. Hansen Title Registered Land Surveyor Registration No. S-498  
(County Surveyor, Registered Land Surveyor, or other duly authorized official)

Office of Register of Deeds, County of Langlade, I hereby certify that the within instrument was filed in this office for record on the \_\_\_\_\_ day of \_\_\_\_\_, 19\_\_\_\_ at \_\_\_\_\_ o'clock \_\_\_\_\_ M.

(Register of Deeds)

By \_\_\_\_\_ Deputy JS

FORM 985 Wisconsin Printing & Stationery Co. Milwaukee, Wisconsin