

CERTIFIED LAND CORNER RESTORATION

Index No. T-13

State of Wisconsin }  
County of Langlade } ss.

I Philip T. Hansen, do hereby certify that on the 21st day of April, 1976, I found evidence of the Quarter corner of Section 27 - 28 Township 34, North, Range 11 East, Fourth Principal Meridian, as described hereon; and that from this evidence I established a new monument and accessories as described hereon to perpetuate the original location of this corner.

Resident witnesses:

Glen Barker

Jim Claflin

Herb Wagoner

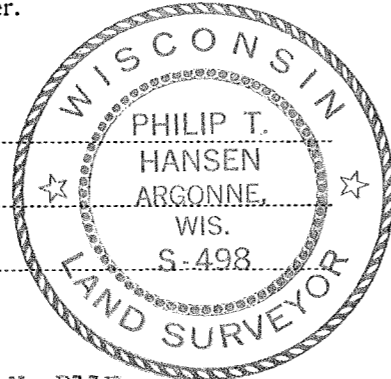

History of original corner establishment: Original corner established by Wm. E. Dougherty, Deputy Surveyor, in 1859, from which Sugar 10" bears N30°W 20 lks, Fir 6" bears S70°E 9 lks.

Corner restored by B.F. Dorr. Set NBT. Birch (double). N22°W 27 lks.

Description of corner evidence found: Recovered 1 1/2" hardwood stake, surrounded by rock cairn. Recovered visible evidence of Dorr's Birch BT (double). Both stumps with bark intact fit the calls. While digging out hole for new monument, recovered remains of original cedar point.

Description of monument and accessories I established to perpetuate the original location of this corner.

Replaced hardwood stake with 2 1/2" iron pipe with brass cap, stamped.

Monument projects 12 inches above ground.

Replaced rock cairn around base.

NBTs - Red Oak 10" N53°W 88 lks, scribed 1/4 BT.

Red Oak 8" S71°W 61.7 lks, scribed 1/4 BT.

Sugar 6" N10°W 33.7 lks, scribed 1/4 BT.

Monument and NBTs painted blue.

S498  
T34N R11E  
1/4 28 | 27  
1976

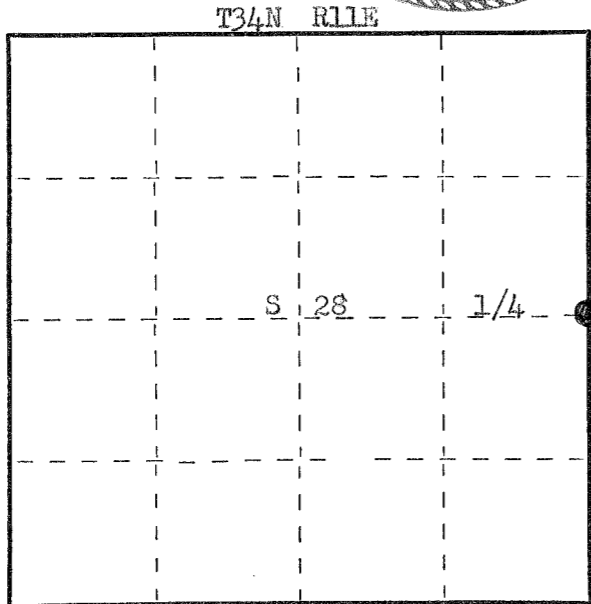

○ = Corner monument restored.

Dated at Rhineland, Wis., this 19th day of May, 1976.

Signature Philip T. Hansen Title Registered Land Surveyor Registration No. S-498  
(County Surveyor, Registered Land Surveyor, or other duly authorized official)

Office of Register of Deeds, County of Langlade, I hereby certify that the within instrument was filed in this office for record on the \_\_\_\_\_ day of \_\_\_\_\_, 19\_\_\_\_ at \_\_\_\_\_ o'clock \_\_\_\_\_ M.

(Register of Deeds)

By \_\_\_\_\_ Deputy