

CERTIFIED LAND CORNER RESTORATION

Index No. U-15

State of Wisconsin }
County of Langlade } ss.

I, Philip T. Hansen, do hereby certify that on the 21st day of April, 1976, I found evidence of the SC 1/16 corner of Section 27 Township 34, North, Range 11 East, Fourth Principal Meridian, as described hereon; and that from this evidence I established a new monument and accessories as described hereon to perpetuate the original location of this corner.

Resident witnesses:

Glen Barker

Jim Claflin

Herb Wagoner

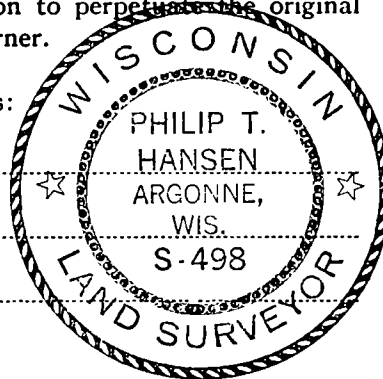

History of original corner establishment:

Corner remonumented by Langlade County Surveyors.

Description of corner evidence found:

Recovered a 2" iron pipe with brass cap stamped.

Monument projects 18" above ground.

Corner sets on west side of Loon Lake road.

Also found an old 3" cedar stake, squared and scribed 1/16 propped up next to the monument.

OBTs - Red Oak 14" N36°W 30 ft. scribed BT.

Maple 3" S72°W 12'7" scribed BT.

Sugar 3" (no notes) S37°W 43 lks, scribed 1/16.

Distances measured to face of BTs.

T34N R11E

SC 1/16

Sec 27

Description of monument and accessories I established to perpetuate the original location of this corner.

Monument and BTs painted blue.

No additional accessories established.

FORM 985 Wisconsin Planning Agency, Inc. Milwaukee, Wisconsin

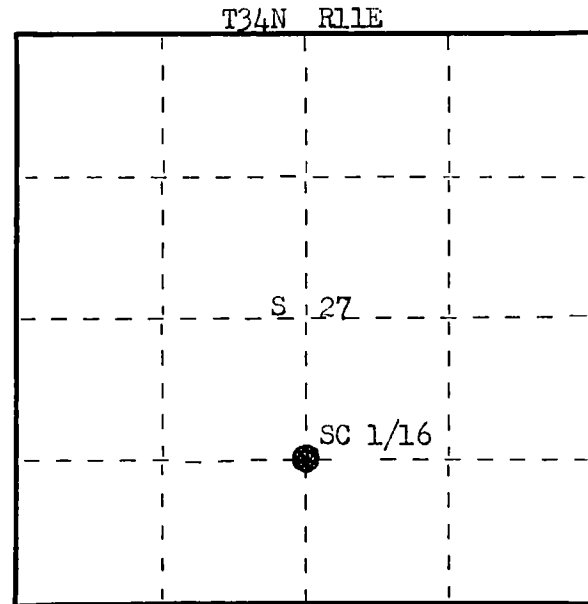

○ = Corner monument restored.

Dated at Rhineland, Wis., this 19th day of May, 1976

Signature Philip T. Hansen Title Registered Land Surveyor Registration No. _____
(County Surveyor, Registered Land Surveyor, or other duly authorized official)

Office of Register of Deeds, County of Langlade, I hereby certify that the within instrument was filed in this office for record on the _____ day of _____, 19____ at _____ o'clock _____ M.

(Register of Deeds)

By _____ Deputy

CERTIFIED LAND CORNER RESTORATION

State of Wisconsin }
County of LANGLADE } ss.

History of original corner establishment:

CORNER SET IN 1950, s BY F.B. WINCENTSEN IN THE plot OF LOON LAKE

I RAYMOND J. HALLISY, do hereby certify that on the 10TH day of MAY, 1969, I found evidence of the S. 1/4 corner of 27 Township 34, North, Range 11E, Fourth, Principal Meridian, as described hereon; and that from this evidence I established a new monument and accessories as described hereon to perpetuate the original location of this corner.

Description of corner evidence found:

OLD SQUARED STAKE DOWN - POINT IN GROUND
OLD BTs, BALSAM 7" S 88° E 20'
SUGAR MAPLE 8" S 31° W 28' 5"

Resident witnesses:

GERALD KRYKA

GERALD WEIX

Description of monument and accessories I established to perpetuate the original location of this corner.

SET 2" IRON PIPE WITH BRASS CAP
BTs TO CORNER: RED OAK 14" N 36° W 30'
RED MAPLE 3" S 72° W 12' 7"

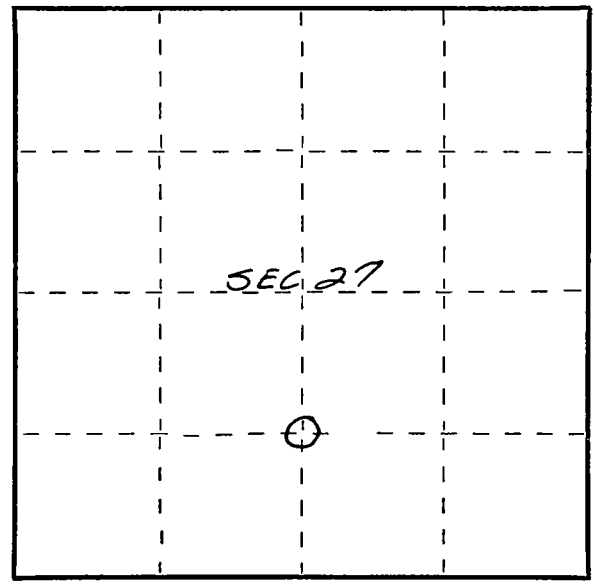

○ = Corner monument restored.

Dated at Antigo, Wis., this 11TH day of MAY, 1969.

Signature Raymond J. Hallisy Title REG. LAND SURVEYOR Registration No. S-685
(County Surveyor, Registered Land Surveyor, or other duly authorized official)

Office of Register of Deeds, County of _____, I hereby certify that the within instrument was filed in this office for record on the _____ day of _____, 19____ at _____ o'clock _____ M.

(Register of Deeds)

By _____ Deputy

FORM 985 H. C. MILLER CO., MILWAUKEE