

CERTIFIED LAND CORNER RESTORATION

Index No. V-14

State of Wisconsin }
County of Langlade } ss.

I Daniel K. Pleoger, do hereby certify that on the 27th day of June, 1980, I ~~found~~ established of the W 1/16 corner of Sections 27 and 34 Township 34, North, Range 11 East, Fourth Principal Meridian, as described hereon; and that from this evidence I established a new monument and accessories as described hereon to perpetuate the original location of this corner.

Resident witnesses:

Glen Barker

Jim Claflin

Herb Wagoner

FORM 985 H. C. MILLER CO., MILWAUKEE

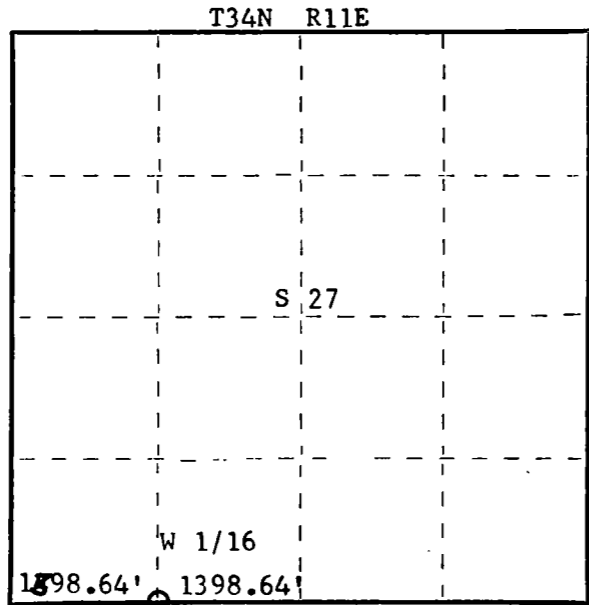

○ = Corner monument restored.

History of original corner establishment:
No record of previous survey.



Description of corner evidence found:

No evidence of any corner recovered.
Corner established by proportion.

Ran traverse from previously established section corner 21, 22, 27, 28 to 1/4 corner between sections 27 and 34 for a distance of 2797.29 feet at bearing N 87° 15' 24" W. Set W 1/16 corner 1398.64 feet intermediate.

Description of monument and accessories I established to perpetuate the original location of this corner.

Set a 1-1/2" iron pipe with a 2" brass cap - stamped:
Monument projects 18" above ground.

Marked NBT's -
Sugar 5" N77°W 14.27 feet
Maple 5" N22°E 6.14 feet
Maple 6" S13°E 15.64 feet
scribed 1/16 BT.

S1537
T34N R11E
W 1/16 S+27
S 34
CPI-1980

Dated at Rhineland, Wis., this 28th day of July, 1980

Signature Daniel K. Pleoger Title Registered Land Surveyor Registration No. S1537
(County Surveyor, Registered Land Surveyor, or other duly authorized official)

Office of Register of Deeds, County of Langlade, I hereby certify that the within instrument was filed in this office for record on the _____ day of _____, 19____ at _____ o'clock _____ M.

(Register of Deeds)

By _____ Deputy