

CERTIFIED LAND CORNER RESTORATION

34-11

Index No. P-25

State of Wisconsin }  
County of Langlade } ss.

I, Raymond J. Hallisy do hereby certify that on the 4th day of October, 1969, I found evidence of the W<sub>1</sub> corner of Section 19 Township T34, North, Range 12E, Fourth, Principal Meridian, as described hereon; and that from this evidence I established a new monument and accessories as described hereon to perpetuate the original location of this corner.

History of original corner establishment:

Corner set in the 1930's by Charles Borth.

Description of corner evidence found:

Found old BT X on rock N21E 111.2 Ft.  
Old point in ground, distance to point correct.

Resident witnesses:

.....  
.....  
.....

Description of monument and accessories I established to perpetuate the original location of this corner.

Set 4" brass cap in cement, rock mound  
B.T.'s to corner  
Jack Pine 9" N28E 86 Ft. 7 inches  
Jack Pine 8" S71E 77 Ft. 5 inches  
B.T.'s faced at base of tree and scribed BT

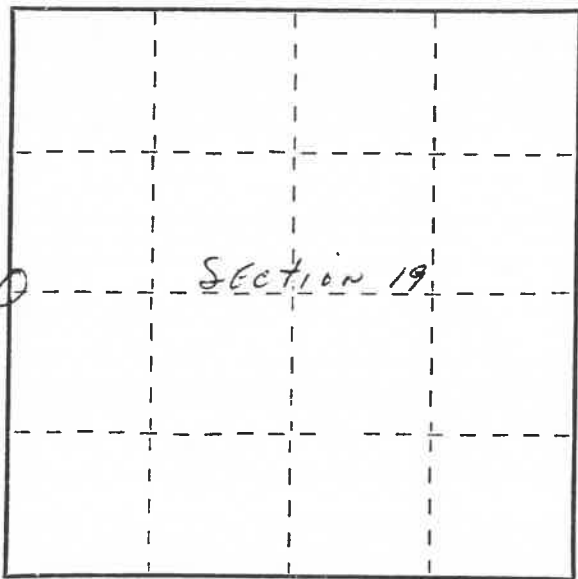
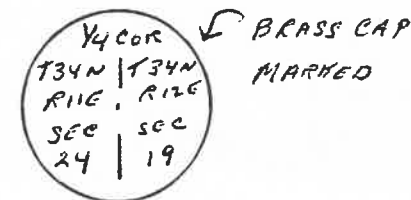

○ = Corner monument restored.

Dated at Antigo, Wis., this 4th day of October, 1969

Signature Raymond J. Hallisy Title Reg. Land Surveyor Registration No. S685  
(County Surveyor, Registered Land Surveyor, or other duly authorized official)

Office of Register of Deeds, County of \_\_\_\_\_, I hereby certify that the within instrument was filed in this office for record on the \_\_\_\_\_ day of \_\_\_\_\_, 19\_\_\_\_ at \_\_\_\_\_ o'clock \_\_\_\_\_ M.

.....  
(Register of Deeds)

By.....Deputy

PLSS field condition report

Date: 4-22-20 Time of day: 1:40

By: Luke Williams

Section 24 Town 34 Range 11  
(circle corner location on diagram)

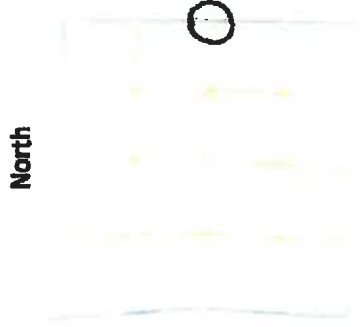

Does the monument appear to be tilted, smashed, uprooted, covered or otherwise damaged by the windstorm? YES  NO

Are any bearing trees broken, uprooted, missing or otherwise damaged by the windstorm? YES  NO

43411 24 2000

TAKE PICTURES

For the first four pictures, do them in this order:

Looking north, looking east, looking south, looking west and, by standing about 6 feet behind the monument, include the monument in each picture.

Then take a picture of the top of the monument, close enough to be able to read what is stamped on the cap. Make sure all pictures are in focus.

P25  
24-11