

CERTIFIED LAND CORNER RESTORATION

Index No. Q-24

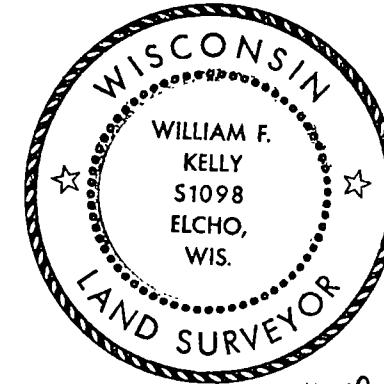

William F. Kelly

State of Wisconsin }
County of LANGLADE } ss.

History of original corner establishment:

I WILLIAM F. KELLY, do hereby certify that on the 9TH day of DECEMBER, 1976, I found evidence of the SE 1/16 corner of SECTION 24 Township 34, North, Range 11E, Fourth Principal Meridian, as described hereon; and that from this evidence I established a new monument and accessories as described hereon to perpetuate the original location of this corner.

Description of corner evidence found:

FOUND 1 1/4" IRON PIPE AND OLD BEARING TREES FROM PREVIOUS SURVEY. CORNER IDENTIFIED AS THE SE 1/16 CORNER BY R.S. LYLE SCOUT CAMP DIRECTOR.

Resident witnesses:

R. S. LYLE SCOUT CAMP DIRECTOR

Description of monument and accessories I established to perpetuate the original location of this corner.

SET 1 1/2" IRON PIPE WITH BRASS CAP AND MARKED NEW BEARING TREES. NOTE: CORNER IS IN A WETLAND AREA.

FORM 985 M. C. MILLER CO., MILWAUKEE

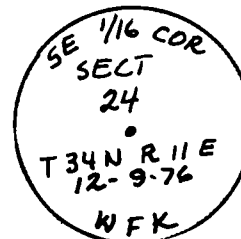
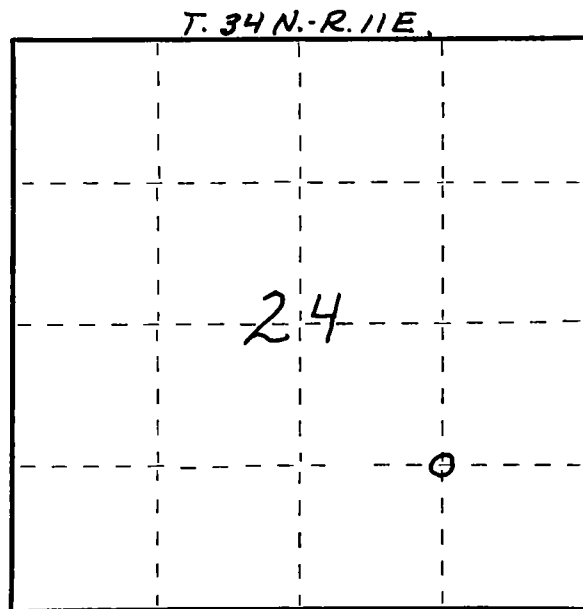

NEW BEARING TREES MARKED:

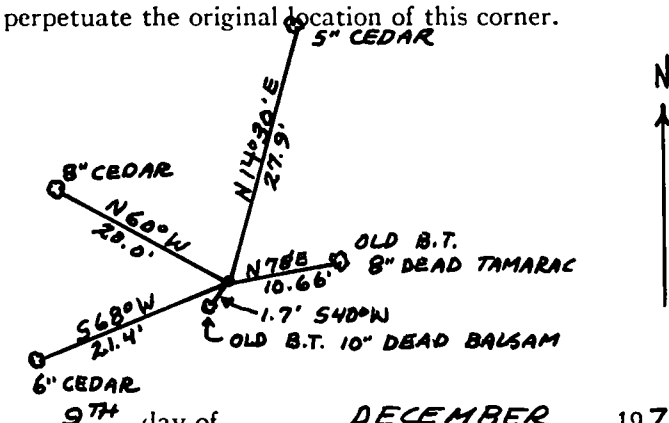

Dated at ELCHO, Wis., this 9TH day of DECEMBER, 1976.

Signature William F. Kelly Title REGISTERED LAND SURVEYOR Registration No. 51098
(County Surveyor, Registered Land Surveyor, or other duly authorized official)

Office of Register of Deeds, County of _____, I hereby certify that the within instrument was filed in this office for record on the _____ day of _____, 19____ at _____ o'clock _____ M.

(Register of Deeds)

By _____ Deputy

○ = Corner monument restored.