

CERTIFIED LAND CORNER RESTORATION

Index No. 0118
M.C.

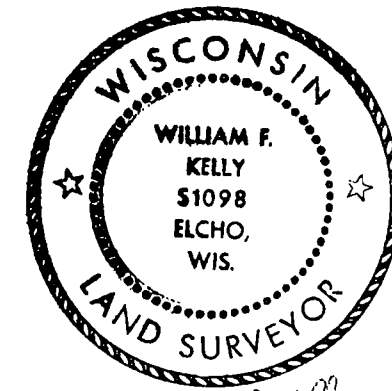

William F. Kelly

State of Wisconsin }
County of LANGLADE } ss.

I WILLIAM F. KELLY, do hereby certify that on the 13th day of OCTOBER, 1974, I found evidence of the MEANDER corner of EAST LINE GOVT LOT 6 Township 34, North, Range 11E, Fourth Principal Meridian, as described hereon; and that from this evidence I established a new monument and accessories as described hereon to perpetuate the original location of this corner.

History of original corner establishment:

Description of corner evidence found:

I LOCATED A RAILROAD RAIL AND A NORWAY PINE WITH A BLAZE MARK ON THE SHORE OF LOWER POST LAKE. THE RAIL IS IN LINE WITH THE W 1/8 Cor. SECT 14/23 T34N-R11E and the N.E. Cor. Govt Lot 6 SECT 23 T34N-R11E.

Resident witnesses:

.....
.....
.....

Description of monument and accessories I established to perpetuate the original location of this corner.

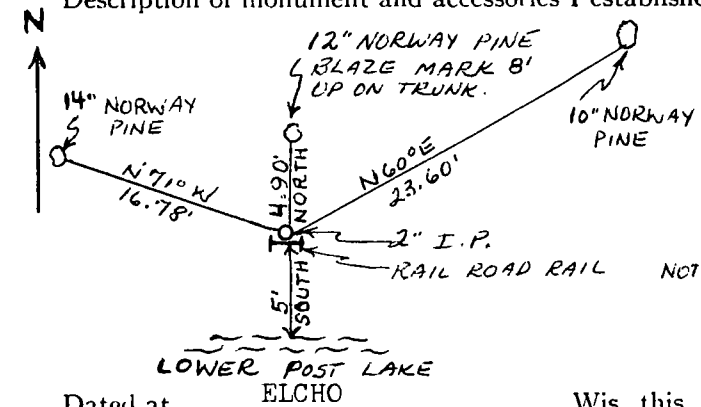

I set a 2" Black Iron Pipe with Brass Cap adjacent to and North of the railroad rail.

NOTE. R.R. RAIL AND 2" I.P. ARE FLUSH WITH GROUND AS THEY ARE LOCATED IN WALKWAY ON SHORE LINE. ALL TREES MARKED WITH A + AT BASE.



FORM 985 M C MILLER CO., MILWAUKEE

T. 34N. - R. 11E.

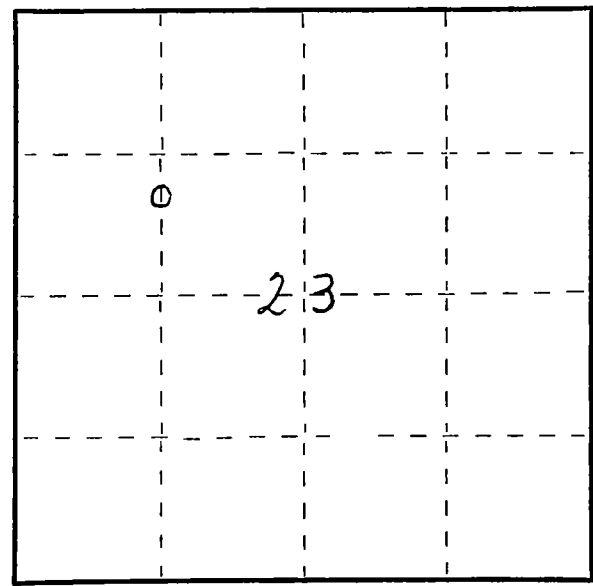

Dated at _____, Wis., this 13th day of OCTOBER, 1974.

Signature William F. Kelly Title REGISTERED LAND SURVEYOR Registration No. S 1098
(County Surveyor, Registered Land Surveyor, or other duly authorized official)

Office of Register of Deeds, County of _____, I hereby certify that the within instrument was filed in this office for record on the _____ day of _____, 19____ at _____ o'clock _____ M.

(Register of Deeds)

By _____ Deputy

○ = Corner monument restored.