

CERTIFIED LAND CORNER RESTORATION

34-11

Index No. Q-21

State of Wisconsin }
County of LANGLADE } ss.

History of original corner establishment:

I W^M F. KELLY, do hereby certify that on the 18TH day of MAY, 1974, I found evidence of the S 1/4 corner of SECS 23 & 24 Township 34, North, Range 11 EAST, Fourth Principal Meridian, as described hereon; and that from this evidence I established a new monument and accessories as described hereon to perpetuate the original location of this corner.

RESET BY POSKIE - CIRCA 1954.

Description of corner evidence found:

FOUND 2" IRON-PIPE-



William F. Kelly

Resident witnesses:

ROBERT J. POSS

Description of monument and accessories I established to perpetuate the original location of this corner.

SET 2" IRON PIPE W/ BRASS CAP MKD.

1. N. PINE 16S 3 1/2 E 35.7
2. N. PINE 17 S 53 E 25.4
FENCE COR N 45° E 22.0
BLAZED & SCRIBED NBT

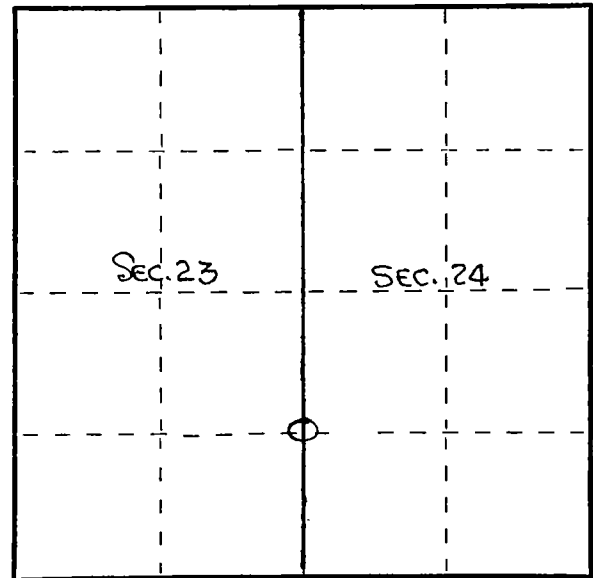
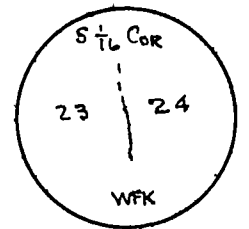

○ = Corner monument restored.

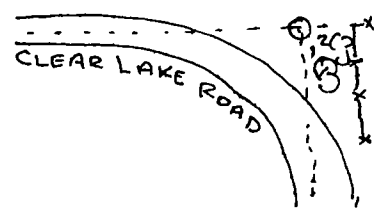

Dated at ELCHO, Wis., this 18TH day of MAY, 1974.

Signature William F. Kelly Title REG. LAND SURVEYOR Registration No. S-1098
(County Surveyor, Registered Land Surveyor, or other duly authorized official)

Office of Register of Deeds, County of _____, I hereby certify that the within instrument was filed in this office for record on the _____ day of _____, 19____ at _____ o'clock _____ M.

(Register of Deeds)

By _____ Deputy