

CERTIFIED LAND CORNER RESTORATION

34-11
Index No. Q-R-17

State of Wisconsin }
County of LANGLADE } ss.

History of original corner establishment:

I, ROBERT J. POSS, do hereby certify that on the 15TH day of JUNE, 19 68, I found evidence of the MEANDER corner ~~of~~ BETWEEN SECS 22 & 23 Township 34, North, Range 11 EAST, Fourth, Principal Meridian, as described hereon; and that from this evidence I established a new monument and accessories as described hereon to perpetuate the original location of this corner.

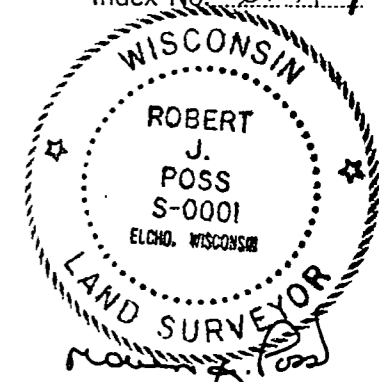

Description of corner evidence found:

SHOWN 1/4 IN PIPE. ACKERMAN DID NOT KNOW WHEN SET BUT ITS VERY OLD.

Resident witnesses:

H. ACKERMAN

Description of monument and accessories I established to perpetuate the original location of this corner.

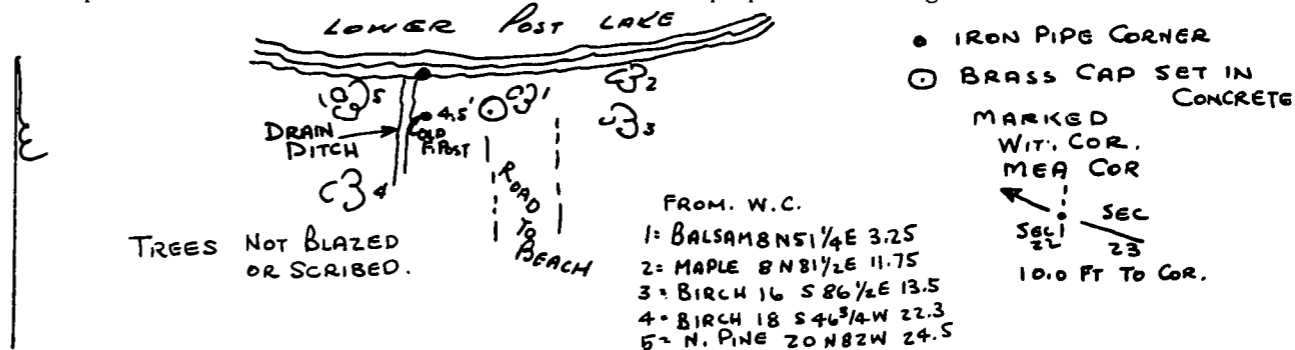
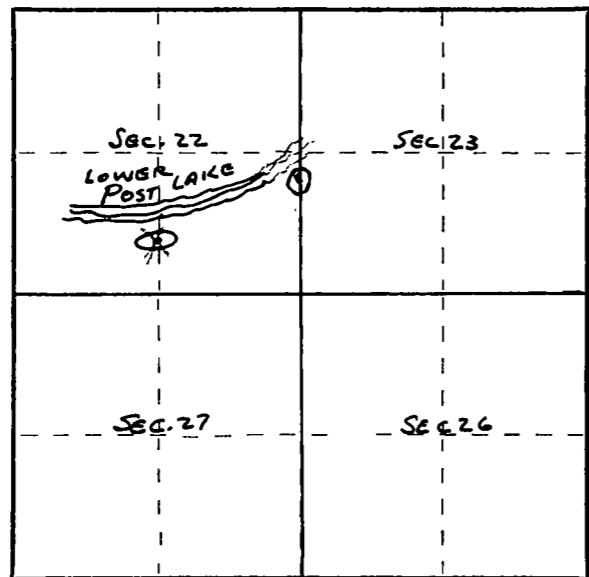

- IRON PIPE CORNER
- BRASS CAP SET IN CONCRETE
- MARKED WIT. COR. MEA COR
- ← 10.0 FT TO COR.

Dated at ELCHO, Wis., this 15TH day of JUNE, 19 68.

Signature Robert J. Poss Title REG. LAND SURVEYOR Registration No. S-1
(County Surveyor, Registered Land Surveyor, or other duly authorized official)

Office of Register of Deeds, County of _____, I hereby certify that the within instrument was filed in this office for record on the _____ day of _____, 19 _____ at _____ o'clock _____ M.

(Register of Deeds)

By _____ Deputy

○ = Corner monument restored.