

CERTIFIED LAND CORNER RESTORATION

34-11
Index No. R-13

State of Wisconsin }
County of LANGLADE } ss.

History of original corner establishment:

I ROBERT J. POSS, do hereby certify that on the 28TH day of JUNE, 1969, I found evidence of the SECTION COR. corner of SECS. 21-22-27-28 Township 34, North, Range 11 EAST, Fourth, Principal Meridian, as described hereon; and that from this evidence I established a new monument and accessories as described hereon to perpetuate the original location of this corner.

Description of corner evidence found:

FOUND B.T.'S BY PREVIOUS SURVEYOR-AND FROM REFERENCES TO OLD B.T.

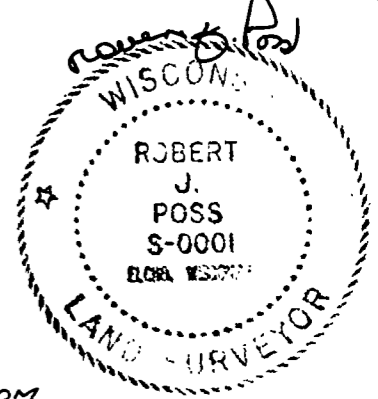

Resident witnesses:

.....
.....
.....

Description of monument and accessories I established to perpetuate the original location of this corner.

○ 1/2" PIPE W/ BRASS CAP.
MKD
WIT. COR NORTH (SOUTH)
50 FT. | SEC. 22
SEC. 21 | SEC. 27
To Cor.
T34N R11E.

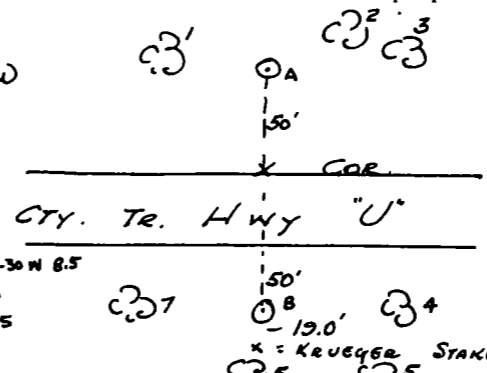

FROM B:
4. R. OAK W/OLD BLAZE 12" S 4 1/2 E 56.7
5. HD. MAPLE W/OLD BLAZE 8" S 2 1/2 E 48.0
6. R. OAK W/BEAVER PELT BLAZE
16" S 14 1/2 W 44.8
7. TWIN MAPLE W/OLD BLAZE
6" S 53 1/2 W 37.0.

FROM COR. 1: N 10° W 48.8
2: N 10 1/2 E 55.6
3: N 21 3/4 E 64.0
4: S 25 1/2 E 101.6
5: S 8 1/2 E 97.0
6: S 12 1/4 W 74.4
7: S 25 W 80.2

FROM A:
1. BLAZED & SCRIBED (OLD)
TWIN HD. MAPLES 8" S 70-30 N 8.5
2. TWIN R. OAK 10" N 57 E 30.0
3. W. BIRCH 6" N 59 E 20.5

Dated at ELCHO, Wis., this 28TH day of JUNE, 1969.

Signature Robert J. Poss Title REG. LAND SURVEYOR Registration No. S-0001
(County Surveyor, Registered Land Surveyor, or other duly authorized official)

Office of Register of Deeds, County of _____, I hereby certify that the within instrument was filed in this office for record on the _____ day of _____, 19____ at _____ o'clock _____ M.

.....
(Register of Deeds)
By _____ Deputy

FORM 985 H. C. MILLER CO., MILWAUKEE

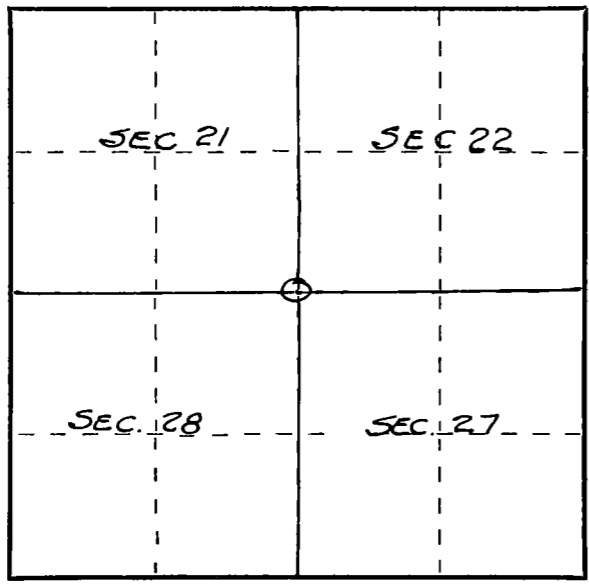

○ = Corner monument restored.