

CERTIFIED LAND CORNER RESTORATION

34-11
Index No. 0-9

State of Wisconsin }
County of LANGLADE } ss.

History of original corner establishment:

I, ROBERT J. POSS, do hereby certify that on the 1ST day of AUGUST, 1970, I found evidence of the NORTH 1/16 corner of SECS. 20 & 21 Township 34, North, Range 11 EAST, Fourth, Principal Meridian, as described hereon; and that from this evidence I established a new monument and accessories as described hereon to perpetuate the original location of this corner.

Description of corner evidence found:

FOUND OLD WELL POINT W/ NEWER WELL POINT ALONG SIDE.

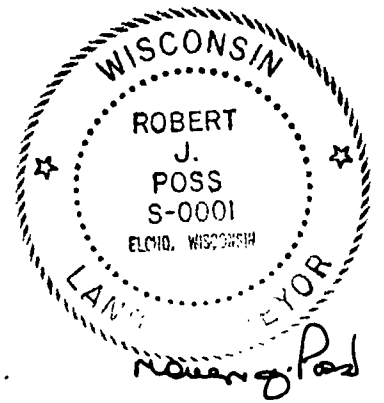

Resident witnesses:

STANLEY MIKOLAJAK

Description of monument and accessories I established to perpetuate the original location of this corner.

SET IRON PIPE PAINTED ORANGE W/ BRASS CAP MKD N 1/16
SEC. 20 SEC. 21
T34N R11E

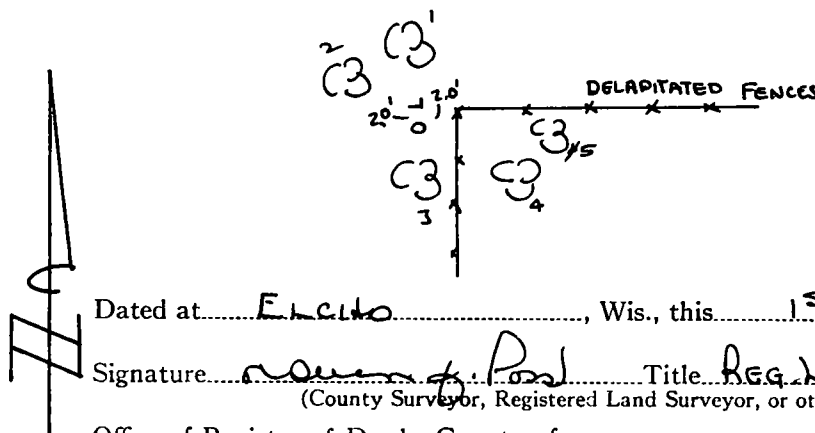
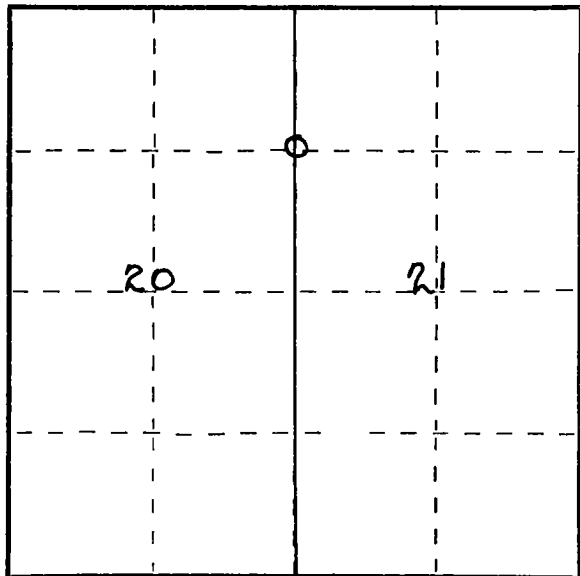

- 1 = W. BIRCH 7 N 17 W 12.4 W/SCAR
- 2 = Y. BIRCH 5 N 66 1/2 W 8.6 OLD BLAZE
- 3 = W. BIRCH 12 S 8 1/2 W 15.2
- 4 = W. BIRCH 12 S 31 E 18.4
- 5 = W. BIRCH 12 S 80 E 17.5

Dated at ELCHO, Wis., this 1ST day of AUGUST, 1970.

Signature Robert J. Poss Title REG. LAND SURVEYOR Registration No. S-0001
(County Surveyor, Registered Land Surveyor, or other duly authorized official)

Office of Register of Deeds, County of _____, I hereby certify that the within instrument was filed in this office for record on the _____ day of _____, 19____ at _____ o'clock _____ M.

(Register of Deeds)

By _____ Deputy

○ = Corner monument restored.