

CERTIFIED LAND CORNER RESTORATION

Index No. P-2

State of Wisconsin }
 County of LANGLADE } ss.

I William F. Kelly, do hereby certify that on the 25th day of OCTOBER, 1979, I found evidence of the W-1/8 COR. E-W 1/4 LINE corner of SECT 19 Township 34, North, Range 11 E, Fourth Principal Meridian, as described hereon; and that from this evidence I established a new monument and accessories as described hereon to perpetuate the original location of this corner.

Resident witnesses:

R. Reynolds

History of original corner establishment:

Corner Est. by C.W. Borth between July & Sept 1934 see Field Notes of Survey in Sect 18 & 19 T34N R11E.

Description of corner evidence found:

LOCATED CORNER CALLED FOR IN C.W. BORTHS NOTES. FOUND WELL POINT AND BEARING TREES

SET NEW 1 1/2" x 42" I.P. WITH BRASS CAP AND MARKED NEW WIT. TREES



W. F. Kelly

Description of monument and accessories I established to perpetuate the original location of this corner.

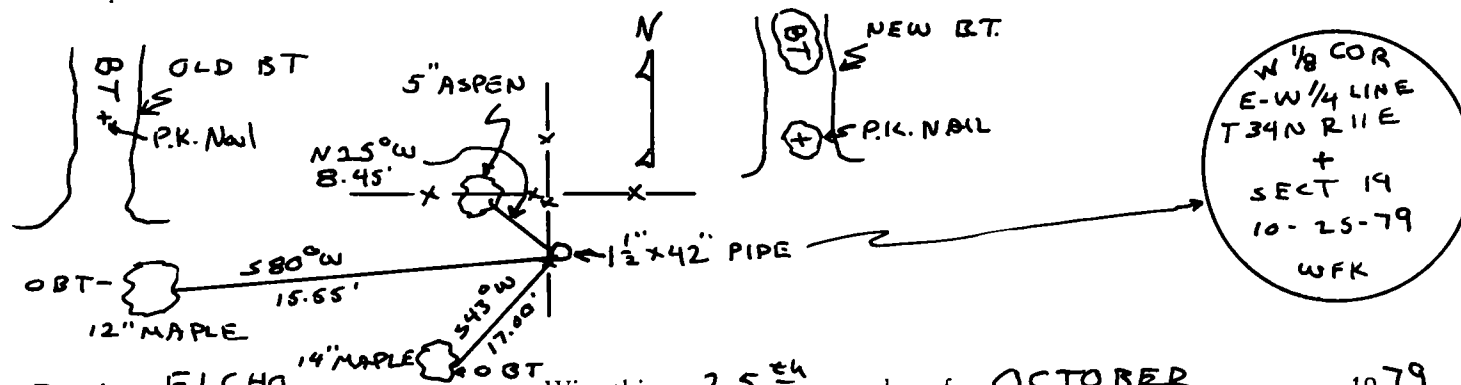

Dated at ELCHO, Wis., this 25th day of OCTOBER, 1979

Signature William F. Kelly Title County Surveyor Registration No. 5-1098
 (County Surveyor, Registered Land Surveyor, or other duly authorized official)

Office of Register of Deeds, County of _____, I hereby certify that the within instrument was filed in this office for record on the _____ day of _____, 19____ at _____ o'clock _____ M.

(Register of Deeds)

By _____ Deputy

FORM 985 H. C. MILLER CO. MILWAUKEE

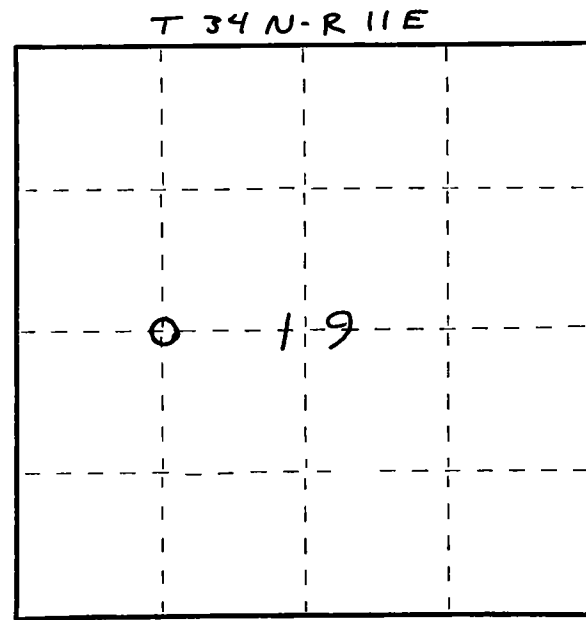

○ = Corner monument restored.