

CERTIFIED LAND CORNER RESTORATION

Index No. R.4

State of Wisconsin }  
County of Langlade } ss.

I Philip T. Hansen, do hereby certify that on the 21st day of October, 1975, I found evidence of the E-1/16 corner of Sections 19-30 Township 34, North, Range 11 East, Fourth Principal Meridian, as described hereon; and that from this evidence I established a new monument and accessories as described hereon to perpetuate the original location of this corner.

Resident witnesses:

Glen Barker

Jim Claflin

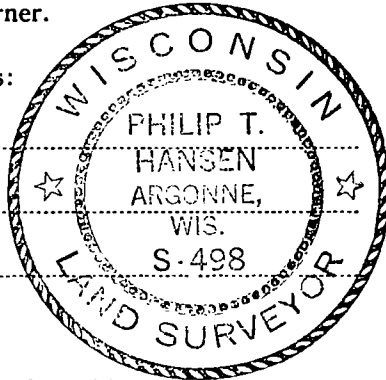

FORM 985  
Wisconsin Planning Advisory Co.  
Madison, Wisconsin

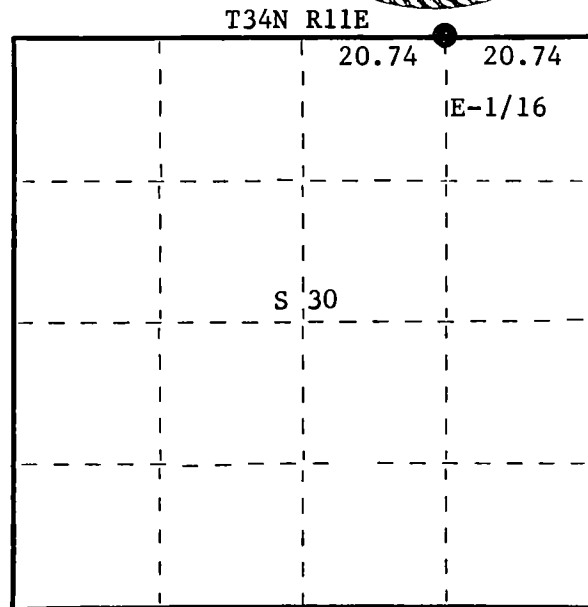

○ = Corner monument restored.

History of original corner establishment:

No record of previous establishment. Ran random from Section Corners 19, 20, 29, and 30, recovered intact, west to point 81' north of Section Corners 19, 30, 24, and 25, a distance of 88.55 chains. Original distance 85.37 chains. Set E-1/16 corner at 20.74 west and 19 links south of random line.

Bearing of corrected line S89°28'W.

Description of corner evidence found:

Description of monument and accessories I established to perpetuate the original location of this corner.

Set 2" iron pipe with brass cap stamped -

Marked NBT's - Maple 10" N23°W 56.7 links scribed 1/16 BT.  
Maple 6" S64°W 21.3 links scribed 1/16 BT.

Pipe projects 12" above ground.  
Pipe and BT's painted blue.

S498  
T34N R11E  
E-1/16 

S	19
S	30

  
1975

Dated at Rhineland, Wis., this 24th day of October, 1975.

Signature Philip T. Hansen Title Registered Land Surveyor Registration No. S-498  
(County Surveyor, Registered Land Surveyor, or other duly authorized official)

Office of Register of Deeds, County of Langlade, I hereby certify that the within instrument was filed in this office for record on the \_\_\_\_\_ day of \_\_\_\_\_, 19\_\_\_\_ at \_\_\_\_\_ o'clock \_\_\_\_\_ M.

(Register of Deeds)

By \_\_\_\_\_ Deputy J.S.