

CERTIFIED LAND CORNER RESTORATION

Index No. M-8

State of Wisconsin }
County of Langlade } ss.

History of original corner establishment:

No evidence of any previous corner.

Description of corner evidence found:

Corner established by subdivision of the SE 1/4 section 17.
SE 1/16 sets 1587.80 feet of EC 1/16 and 1321.12' of SC 1/16.

Description of monument and accessories I established to perpetuate the original location of this corner.

Set a 1" iron pipe with 2" diameter alloy cap, stamped:
Monument projects 18" above ground.

Marked NBT's:

Sugar 6" N44E 40.15 feet
Sugar 8" N9°W 38.68 feet
scribed 1/16-B.T.

S-1682
T34N R11E
SE 1/16 S+17
CPI-1983

I Glen Barker, do hereby
certify that on the 26th day
of October, 1983, I ~~found~~
~~established~~ established
~~the~~ SE 1/16
corner of Section 17
Township 34, North, Range
11 East, Fourth Principal Meridian,
as described hereon; and that from this evidence
I established a new monument and accessories
as described hereon to perpetuate the original
location of this corner.

Resident witnesses:

J. Claflin, Reg

H. Wagoner

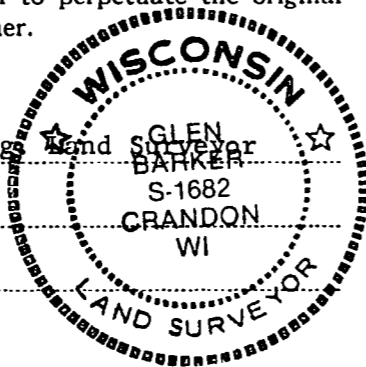

T34N R11E

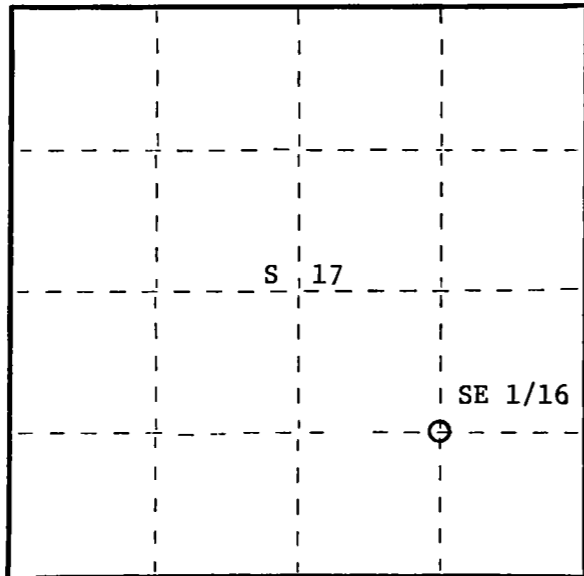

○ = Corner monument restored.

Dated at Rhineland, Wis., this 19th day of December, 1983

Signature Glen Barker Title Registered Land Surveyor Registration No. S-1682
(County Surveyor, Registered Land Surveyor, or other duly authorized official)

Office of Register of Deeds, County of _____, I hereby certify that the within
instrument was filed in this office for record on the _____ day of _____, 19____
at _____ o'clock _____ M.

(Register of Deeds)

By _____ Deputy

FORM 985 H.C. Miller Company Stock No. 26272