

CERTIFIED LAND CORNER RESTORATION

Index No. M-9

State of Wisconsin }
County of Langlade } ss.

History of original corner establishment:

Fence corner running north-east bears S32-48-38E 54.92 feet of present monument.

I Glen Barker, do hereby certify that on the 26th day of October, 1983, I ~~for~~ established ~~at~~ the S 1/16 corner of Sections 16 & 17 Township 24, North, Range 11 East, Fourth Principal Meridian, as described hereon; and that from this evidence I established a new monument and accessories as described hereon to perpetuate the original location of this corner.

Description of corner evidence found:

Total distance from section corner 16-17-20-21 to 1/4 corner between sections 16 & 17 is 2886.03 feet.
Set S 1/16 1443.015 feet intermediate.

Resident witnesses:

J. Claflin, Reg. Land Surveyor

H. Wagoner

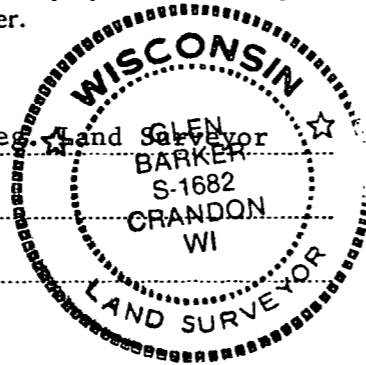

Description of monument and accessories I established to perpetuate the original location of this corner.

Set a 1" iron pipe with 2" diameter alloy cap, stamped:
Monument projects 18" above ground.

Marked NBT's:

Sugar 8" S28W 25.25 feet
Sugar 9" N20W 29.15 feet
scribed 1/16-B.T.

S1682
T34N R11E
S 1/16 17+16
CPI-1983

FORM 985 H.C. Miller Company Stock No. 26272

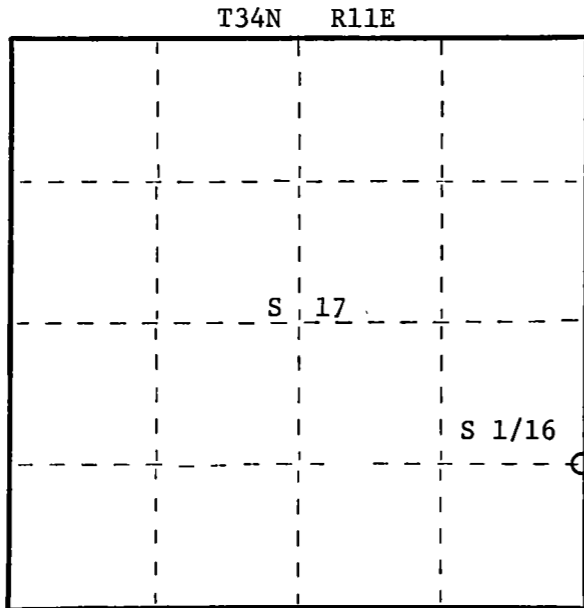

○ = Corner monument restored.

Dated at Rhinelander, Wis., this 19th day of December, 1983.

Signature Glen Barker Title Registered Land Surveyor Registration No. S-1682
(County Surveyor, Registered Land Surveyor, or other duly authorized official)

Office of Register of Deeds, County of _____, I hereby certify that the within instrument was filed in this office for record on the _____ day of _____, 19____ at _____ o'clock _____ M.

(Register of Deeds)

By _____ Deputy