

CERTIFIED LAND CORNER RESTORATION

Index No. K-22

State of Wisconsin }  
County of LANGLADE } ss.

I, ROBERT J. POSS, do hereby certify that on the 29<sup>TH</sup> day of MAY, 1970, I found evidence of the NW 1/4 corner of SECTION 13 Township 34, North, Range 11 EAST, Fourth, Principal Meridian, as described hereon; and that from this evidence I established a new monument and accessories as described hereon to perpetuate the original location of this corner.

Resident witnesses:  
.....  
.....  
.....

History of original corner establishment:

Description of corner evidence found:

FOUND OLD 3/4" x 24" IRON BOLT.  
NO OLD BLAZES OR OTHER MARKS.



Description of monument and accessories I established to perpetuate the original location of this corner

SET 1 1/4" IRON PIPE W/GALV. CAP. MKD NW 1/4  
SEC. 13  
T 34 N R 11 E

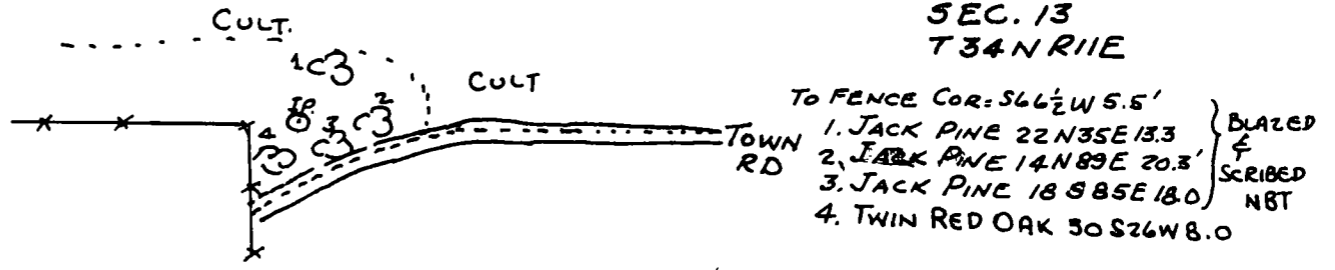

FORM 985 N. C. MILLER CO., MILWAUKEE

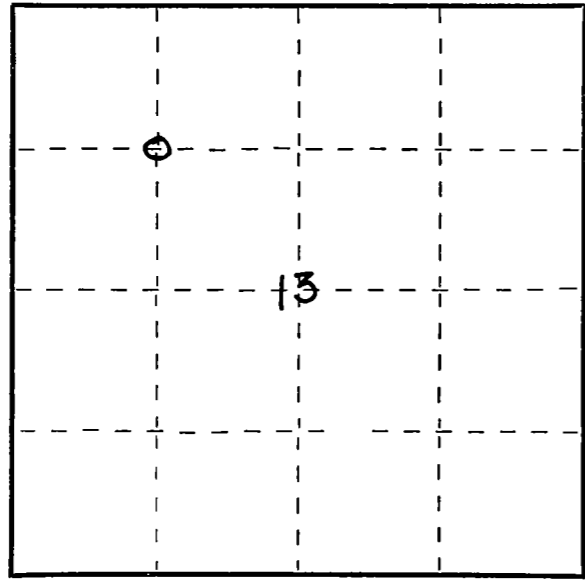

○ = Corner monument restored.

Dated at ELCHO, Wis., this 29<sup>TH</sup> day of MAY, 1970

Signature Robert J. Poss Title REG. LAND SURVEYOR Registration No. S-0001  
(County Surveyor, Registered Land Surveyor, or other duly authorized official)

Office of Register of Deeds, County of....., I hereby certify that the within instrument was filed in this office for record on the..... day of....., 19..... at..... o'clock..... M.

.....  
(Register of Deeds)

By..... Deputy