

CERTIFIED LAND CORNER RESTORATION

34-11

Index No. L-18

State of Wisconsin }  
 County of LANGLADE } ss.

I, ROBERT J. POSE, do hereby certify that on the 28<sup>TH</sup> day of JUNE, 1968, I found evidence of the WEST 1/16 corner ON 1/4 SEC. LINE SEC. 14 Township 34, North, Range 11 EAST, Fourth, Principal Meridian, as described hereon; and that from this evidence I established a new monument and accessories as described hereon to perpetuate the original location of this corner.

Resident witnesses:

.....  
 .....  
 .....

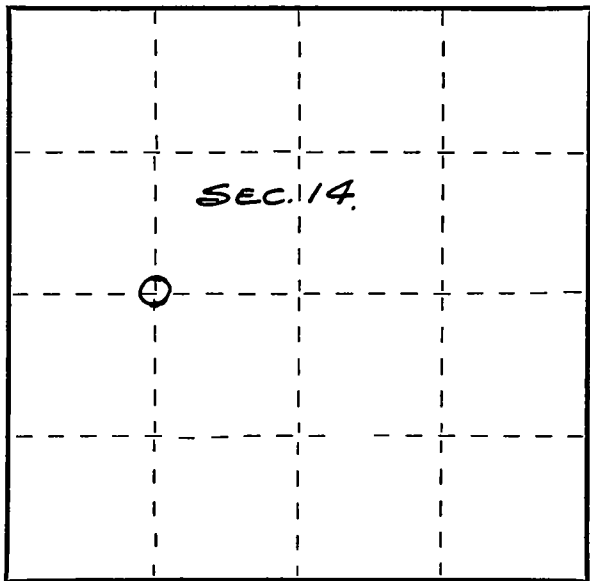

○ = Corner monument restored.

History of original corner establishment:

Description of corner evidence found:

FOUND IRON PIN UNDER BLACK TOP.  
6/5/03 D.T. FND 1" IRON ROD W 1/4" SQ HEAD, 0.65' BELOW PAUT  
SET NAIL & FLAGGING 1.00' N & 1.00' E - REPLACED PAUT.

Description of monument and accessories I established to perpetuate the original location of this corner.

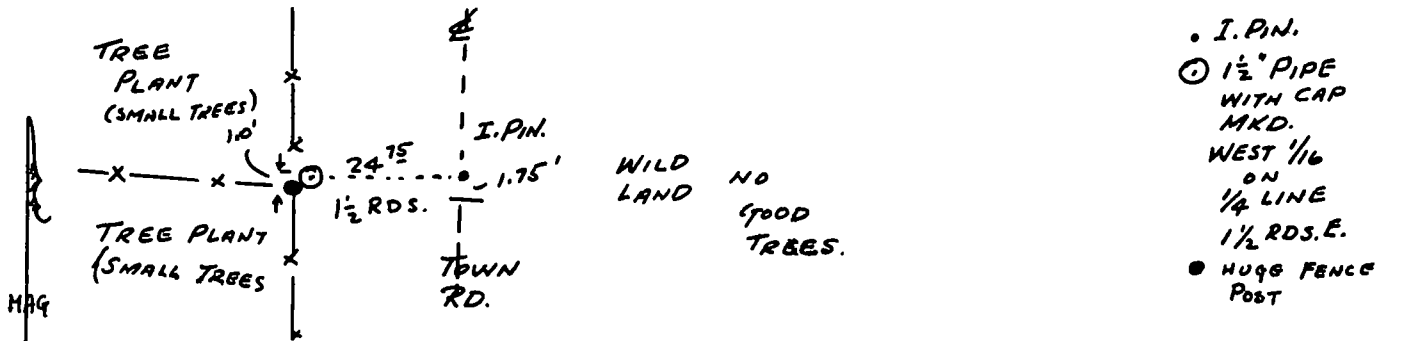

Dated at ELCHO, Wis., this 28<sup>TH</sup> day of JUNE, 1968.

Signature Robert J. Pose Title REG. LAND SURVEYOR Registration No. S-1  
 (County Surveyor, Registered Land Surveyor, or other duly authorized official)

Office of Register of Deeds, County of \_\_\_\_\_, I hereby certify that the within instrument was filed in this office for record on the \_\_\_\_\_ day of \_\_\_\_\_, 19\_\_\_\_ at \_\_\_\_\_ o'clock \_\_\_\_\_ M.

(Register of Deeds)

By \_\_\_\_\_ Deputy