

CERTIFIED LAND CORNER RESTORATION

34-11

Index No. M-21

State of Wisconsin }  
County of LANGLEADE } ss.

History of original corner establishment:

I W<sup>m</sup> F. KELLY, do hereby certify that on the 18<sup>TH</sup> day of MAY, 1974, I found evidence of the S. 1/16 corner of Secs. 13 & 14 Township 34 North, Range 11 East, Fourth Principal Meridian, as described hereon; and that from this evidence I established a new monument and accessories as described hereon to perpetuate the original location of this corner.

Description of corner evidence found:

FOUND SQD STAKE BADLY ROTTED  
SCRIBE MARKS BARELY VISIBLE

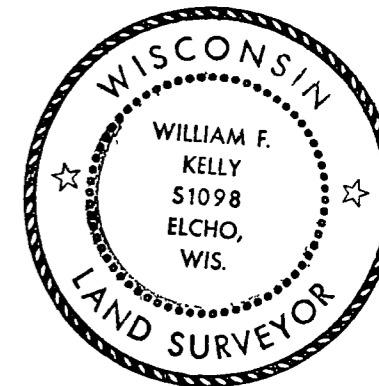

William F. Kelly

Resident witnesses:

ROBERT MARX

ROBERT J. POSS

Description of monument and accessories I established to perpetuate the original location of this corner.

SET 2" IRON PIPE W/ BRASS CAP. MKD.

FORM 985 H. C. MILLER CO., MILWAUKEE

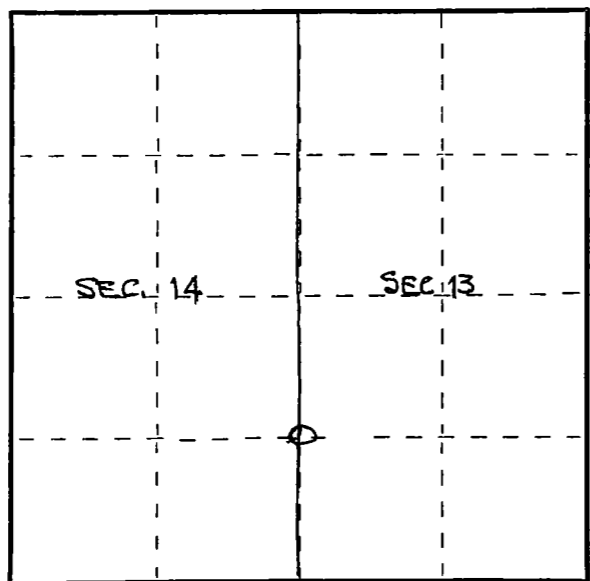

○ = Corner monument restored.



1 = J. PINE 10 N 72 W 24.7  
2 = J. PINE 8 N 70 E 18.5  
3 = J. PINE 16 S 8 E 26.6  
BLAZED & SCRIBED NBT  
4 = J. PINE 16 - 37' E. of Post

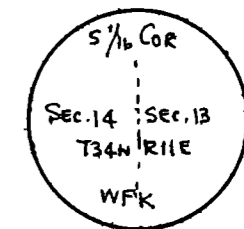

Dated at ELCHO, Wis., this 18<sup>TH</sup> day of MAY, 1974

Signature: William F. Kelly Title: REG. LAND SURVEYOR Registration No. S-1098  
(County Surveyor, Registered Land Surveyor, or other duly authorized official)

Office of Register of Deeds, County of \_\_\_\_\_, I hereby certify that the within instrument was filed in this office for record on the \_\_\_\_\_ day of \_\_\_\_\_, 19\_\_\_\_ at \_\_\_\_\_ o'clock \_\_\_\_\_ M.

(Register of Deeds)

By \_\_\_\_\_ Deputy