

CERTIFIED LAND CORNER RESTORATION

34-11

Index No. N-19

State of Wisconsin }
County of LANGLADE } ss.

I, ROBERT J. POSS, do hereby certify that on the 26TH day of APRIL, 1969, I found evidence of the 1/4 corner of BETWEEN SECS. 14 & 23 Township 34, North, Range 11 EAST, Fourth, Principal Meridian, as described hereon; and that from this evidence I established a new monument and accessories as described hereon to perpetuate the original location of this corner.

Resident witnesses:

M. ROY BURTON

History of original corner establishment:

BELIEVED SET BY MALCOLM HUTCHINSON CIRCA 1920.

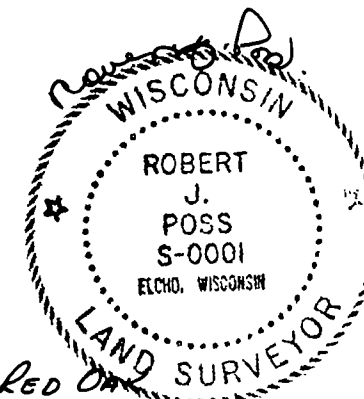

Description of corner evidence found:

MODEL "T" FORD AXLE 1 SCARRED RED OAK
NO INFORMATION ON WHO SET CORNER
NO OLD BT'S (ORIG.) SCAR ON OAK ONLY

Description of monument and accessories I established to perpetuate the original location of this corner.

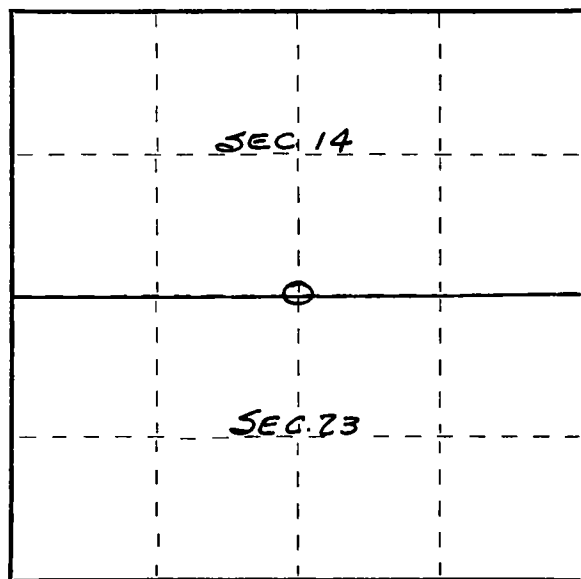
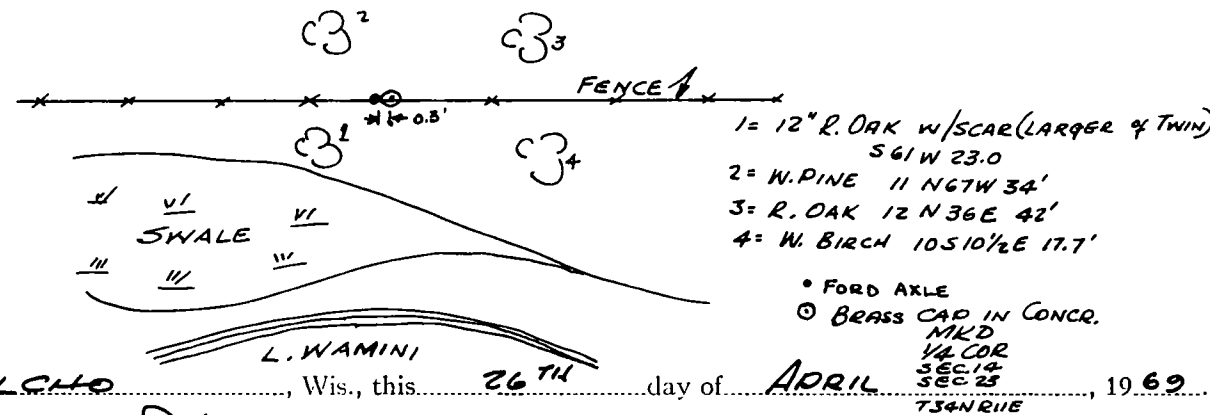

○ = Corner monument restored.

Dated at ELCHO, Wis., this 26TH day of APRIL, 1969

Signature Robert J. Poss Title REG. LAND SURVEYOR Registration No. S-0001
(County Surveyor, Registered Land Surveyor, or other duly authorized official)

Office of Register of Deeds, County of _____, I hereby certify that the within instrument was filed in this office for record on the _____ day of _____, 19____ at _____ o'clock _____ M.

(Register of Deeds)

By _____ Deputy

NOTE: TREES BLAZED & SCRIBED NBT BOTH BLAZES - BASE OF TREE & CHEST HIGH.