

CERTIFIED LAND CORNER RESTORATION

State of Wisconsin }
County of Langlade } ss.

History of original corner establishment:

Corner set in the 1930's by Charles Borth.

I Raymond J. Hallisy, do hereby certify that on the 4th day of October, 1969, I found evidence of the W 1/4 corner of Section 18 Township T34 North, Range 12E, Fourth, Principal Meridian, as described hereon; and that from this evidence I established a new monument and accessories as described hereon to perpetuate the original location of this corner.

Description of corner evidence found:

Found old wood stake standing. Marked S13 S18
Old B.T.'s:
Pine Stump N25W
Spruce S73W

Resident witnesses:

.....
.....
.....

Description of monument and accessories I established to perpetuate the original location of this corner.

Set 4" brass cap in cement
B.T.'s to corner
Jack Pine 8" N44E 35 Ft. 9 inches
Blace Spruce 7" S84W 11Ft. 1 inch
B.T.'s faced at base of tree and scribed BT

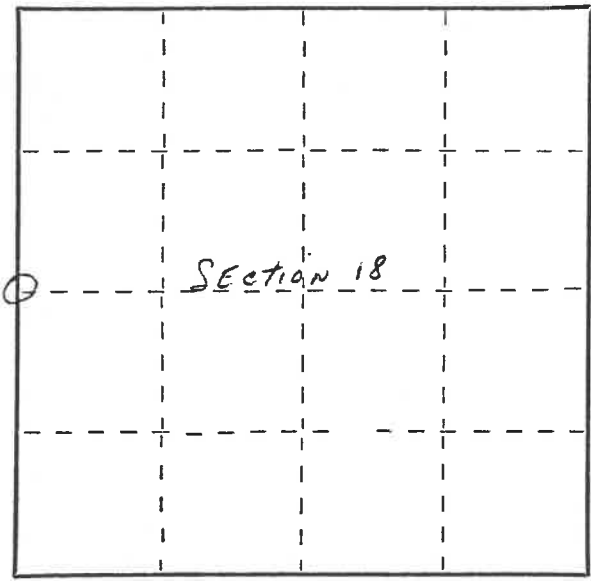
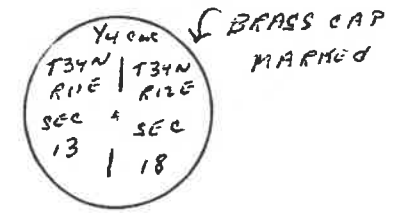

○ = Corner monument restored.

Dated at Antigo, Wis., this 4th day of October, 1969.

Signature Raymond J. Hallisy Title Reg. Land Surveyor Registration No. S-685
(County Surveyor, Registered Land Surveyor, or other duly authorized official)

Office of Register of Deeds, County of, I hereby certify that the within instrument was filed in this office for record on the day of, 19 at o'clock M.

(Register of Deeds)

By Deputy

FORM 905 W. C. MILLER CO., MILWAUKEE

PLSS field condition report

Date: 4-22-20 Time of day: 1:00 PM

By: Luke Williams

Section 13 Town 34 Range 11
(circle corner location on diagram)

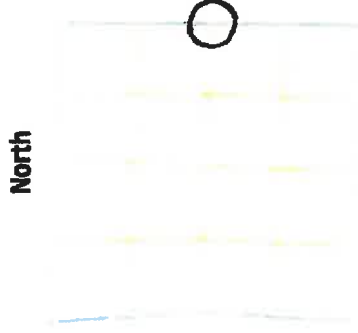

Does the monument appear to be tilted, smashed, uprooted, covered or otherwise damaged by the windstorm?

YES NO

Are any bearing trees broken, uprooted, missing or otherwise damaged by the windstorm? YES NO

434113 2000

TAKE PICTURES

For the first four pictures, do them in this order:

Looking north, looking east, looking south, looking west and, by standing about 6 feet behind the monument, include the monument in each picture.

Then take a picture of the top of the monument, close enough to be able to read what is stamped on the cap. Make sure all pictures are in focus.

L25
34-11