

CERTIFIED LAND CORNER RESTORATION

34-11

Index No. F-22

State of Wisconsin }  
County of LANGLADE, } ss.

History of original corner establishment:

IRON PIPE SET BY C. BORTH 1955

I ROBERT J. POSS do hereby certify that on the 24<sup>TH</sup> day of JULY, 1971, I found evidence of the NW 1/16 corner of SEC. 12 Township 34, North, Range 11 EAST, Fourth, Principal Meridian, as described hereon; and that from this evidence I established a new monument and accessories as described hereon to perpetuate the original location of this corner.

Description of corner evidence found:

1" IRON PIPE, - REMAINS OF WOOD STAKE

Resident witnesses:

D. WARG

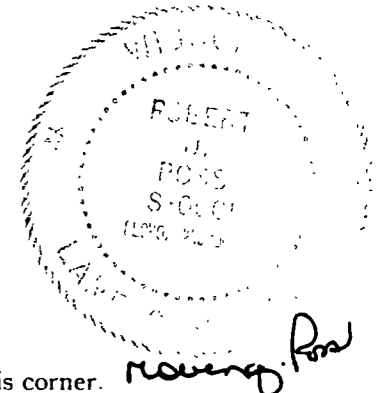

Description of monument and accessories I established to perpetuate the original location of this corner.

SET 2" IRON PIPE W/ BRASS CAP MKD

NW 1/16  
SEC. 12  
34-11.

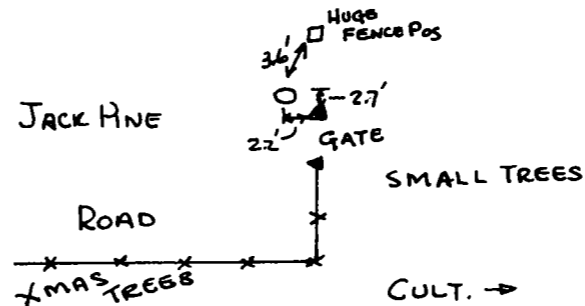
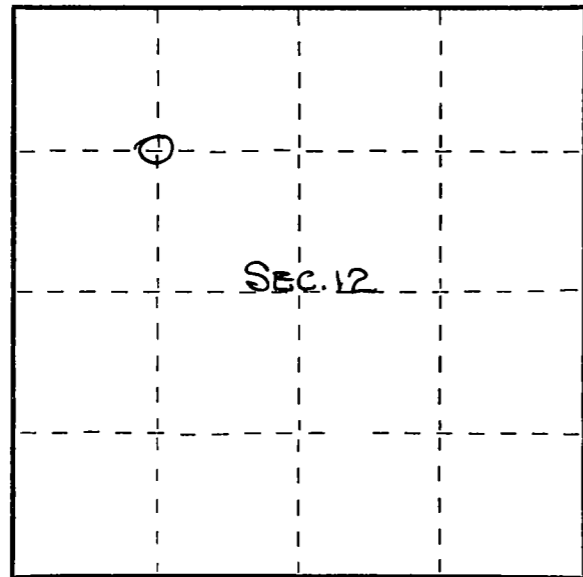

Dated at ELCINO, Wis., this 24<sup>TH</sup> day of JULY, 1971.

Signature Robert J. Poss Title REG. LAND SURVEYOR Registration No. S-0001  
(County Surveyor, Registered Land Surveyor, or other duly authorized official)

Office of Register of Deeds, County of \_\_\_\_\_, I hereby certify that the within instrument was filed in this office for record on the \_\_\_\_\_ day of \_\_\_\_\_, 19\_\_\_\_ at \_\_\_\_\_ o'clock \_\_\_\_\_ M.

(Register of Deeds)

By \_\_\_\_\_ Deputy

○ = Corner monument restored.

FORM 985 H. C. MILLER CO., MILWAUKEE