

CERTIFIED LAND CORNER RESTORATION

Index No. F-6

State of Wisconsin }
County of Langlade } ss.

I, Philip T. Hansen, do hereby certify that on the 16th day of April, 1980, I ~~found~~ ^{established} ~~the~~ ^{the} NW 1/16 corner of Section 8 Township 34, North, Range 11 East, Fourth Principal Meridian, as described hereon; and that from this evidence I established a new monument and accessories as described hereon to perpetuate the original location of this corner.

Resident witnesses:

Glen Barker

Jim Claflin

Herb Wagoner

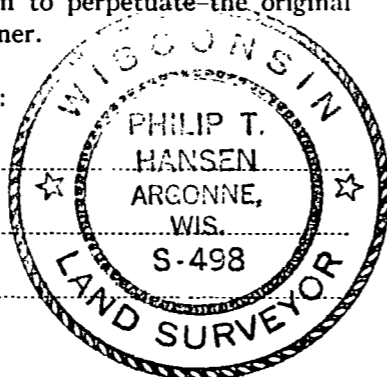

FORM 985 H. C. MILLER CO., MILWAUKEE

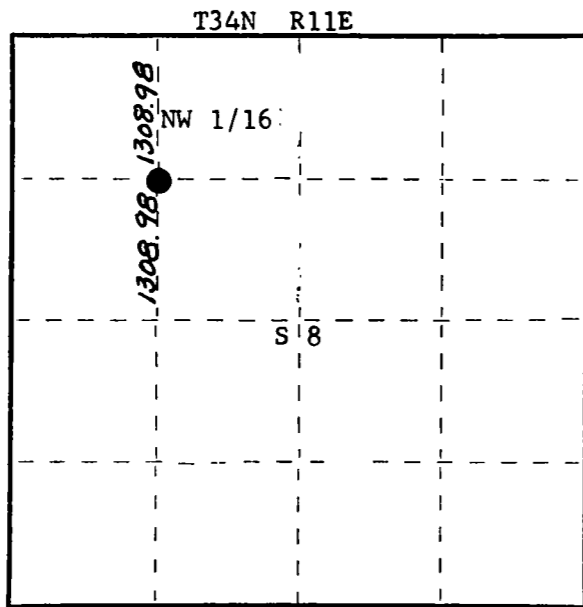

○ = Corner monument restored.

History of original corner establishment:

Description of corner evidence found:

No evidence of any corner recovered. Corner established by traverse and computation. Computed distance from W 1/16 between 5 and 8 to the WC 1/16, section 8 is 2617.94' at bearing S 1° 34' 44" E. Computed location of NW 1/16 is 1308.96, S 1° 34' 96" E of W 1/16 and 1308.98' N 1° 34" 44" W of WC 1/16.

Description of monument and accessories I established to perpetuate the original location of this corner.

Set a 1-1/2" I.D. iron pipe with screw-on brass cap, stamped: Monument projects 16" above ground.

Marked NBT's -

Maple 6" S 15° E 18.45'
Maple 6" (cluster) S 64° E 38.33'
both scribed 1/16 BT.

T34N R11E
NW 1/16 S + 8
S498 - 1980

Dated at Rhineland, Wis., this 18th day of April, 1980

Signature Philip T. Hansen Title Registered Land Surveyor Registration No. S-498
(County Surveyor, Registered Land Surveyor, or other duly authorized official)

Office of Register of Deeds, County of Langlade, I hereby certify that the within instrument was filed in this office for record on the _____ day of _____, 19____ at _____ o'clock _____ M.

(Register of Deeds)

By _____ Deputy