

CERTIFIED LAND CORNER RESTORATION

Index No. F-9

State of Wisconsin }
County of Langlade } ss.

I Philip T. Hansen, do hereby certify that on the 21st day of April, 1980, I ~~found~~ established ~~the~~ N. 1/16 corner of Sections 8 and 9 Township 34, North, Range 11 East, Fourth Principal Meridian, as described hereon; and that from this evidence I established a new monument and accessories as described hereon to perpetuate the original location of this corner.

History of original corner establishment:

No records of any previous surveys.

Resident witnesses:

Glen Barker

Jim Claflin

Herb Wagoner

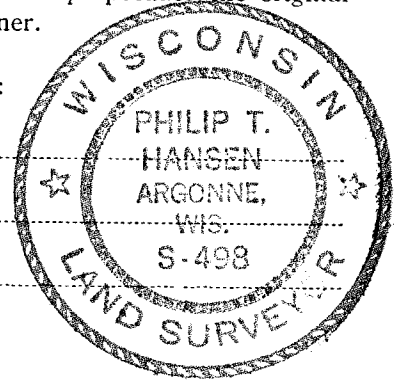

Description of corner evidence found:

No evidence of any corner recovered. Corner established by traverse and computation. Ran traverse from section corner 4, 5, 8 and 9 to 1/4 corner between sections 8 and 9. Computed distance found to be 2483.76 feet at bearing S 1° 34' 30" W. Set the N 1/16 at 1241.98 feet intermediate.

Description of monument and accessories I established to perpetuate the original location of this corner.
Set a 1-1/2" I.D. iron pipe with screw-on brass cap, stamped:
Monument projects 12" above ground.

Marked NBT's -
Sugar 8" N44°E 40.65'
W.Spruce 6" S26°E 32.94'

T34N R11E
N 1/16 ⁸+⁹
S498 - 1980

FORM 963 H. C. MILLER CO., MILWAUKEE

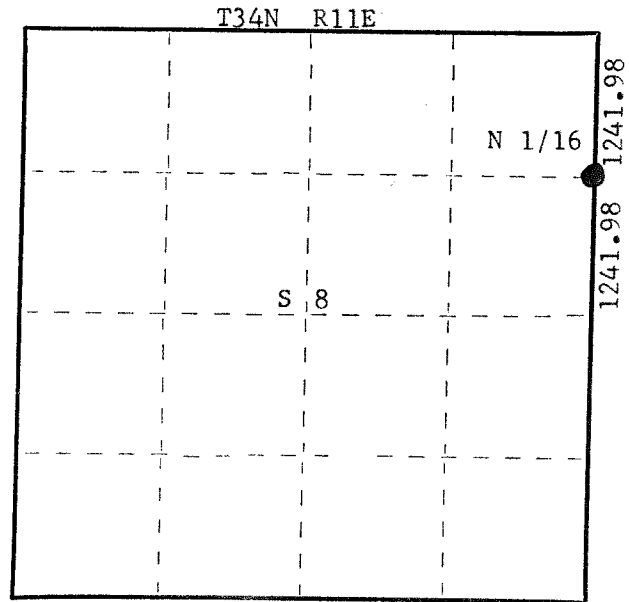

○ = Corner monument restored.

Dated at Rhineland, Wis., this 25th day of April, 1980

Signature: Philip T. Hansen Title Registered Land Surveyor Registration No. S-498
(County Surveyor, Registered Land Surveyor, or other duly authorized official)

Office of Register of Deeds, County of Langlade, I hereby certify that the within instrument was filed in this office for record on the _____ day of _____, 19____ at _____ o'clock _____ M.

(Register of Deeds)

By _____ Deputy