

CERTIFIED LAND CORNER RESTORATION

Index No. F-5

State of Wisconsin }  
County of Langlade } ss.

I, Philip T. Hansen, do hereby certify that on the 6th day of April, 1980, I ~~found~~ established ~~the~~ N 1/16 corner of Sections 7 and 8 Township 34, North, Range 11 East, Fourth Principal Meridian, as described hereon; and that from this evidence I established a new monument and accessories as described hereon to perpetuate the original location of this corner.

Resident witnesses:

Glen Barker

Jim Claflin

Herb Wagoner

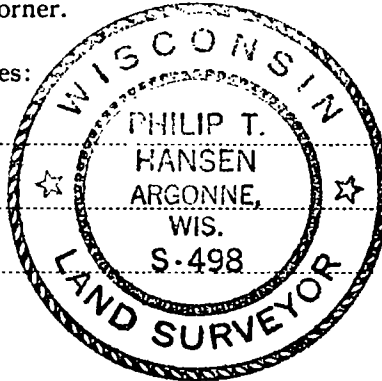

FORM 985 H. C. MILLER CO., MILWAUKEE

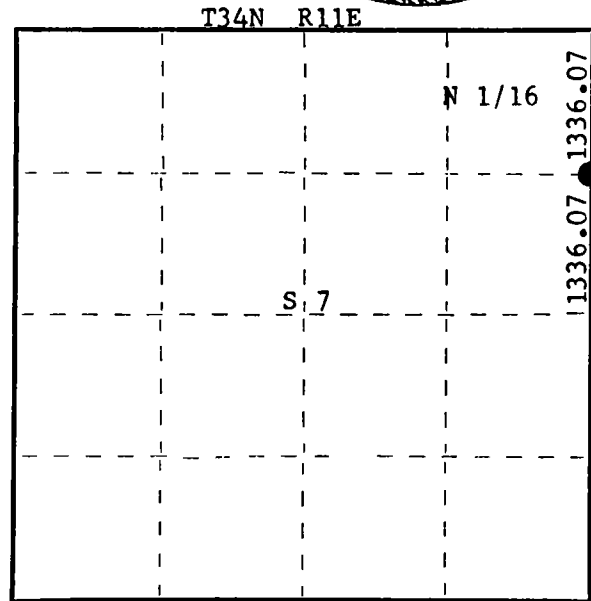

○ = Corner monument restored.

History of original corner establishment:

Description of corner evidence found:

No evidence of any corner recovered. Corner established by traverse and computation. Ran traverse from 1/4 corner between sections 7 and 8 to the section corner 5, 6, 7 and 8, bearing N 4° 48' 33" W, distance 2672.14 feet. Set N 1/16 at 1336.07 feet intermediate.

Description of monument and accessories I established to perpetuate the original location of this corner.

Set a 1-1/2" I.D. iron pipe with screw-on brass cap, stamped: Monument projects 18". Built a rock cairn around base of monument.

Marked NBT's -  
Sugar 6" S81°W 14.10'  
Sugar 8" S60°E 22.40'  
both scribed 1/16 BT.

T34N R11E  
N 1/16 <sup>7</sup>+<sup>8</sup>  
S498 - 1980

Dated at Rhineland, Wis., this 18th day of April, 1980

Signature Philip T. Hansen Title Registered Land Surveyor Registration No. S-498  
(County Surveyor, Registered Land Surveyor, or other duly authorized official)

Office of Register of Deeds, County of Langlade, I hereby certify that the within instrument was filed in this office for record on the \_\_\_\_\_ day of \_\_\_\_\_, 19\_\_\_\_ at \_\_\_\_\_ o'clock \_\_\_\_\_ M.

(Register of Deeds)

By \_\_\_\_\_ Deputy