

CERTIFIED LAND CORNER RESTORATION

Index No. 5

State of Wisconsin }
County of LANGLADE } ss.

I William F. Kelly, do hereby certify that on the 19th day of NOVEMBER, 1975, I found evidence of the 1/4 SECTION corner of SECTION 6 & 5 Township 34, North, Range 11E, Fourth Principal Meridian, as described hereon; and that from this evidence I established a new monument and accessories as described hereon to perpetuate the original location of this corner.

Resident witnesses:

G. MOORE

J. DREW

FORM 985 H & C MILLER CO., MILWAUKEE

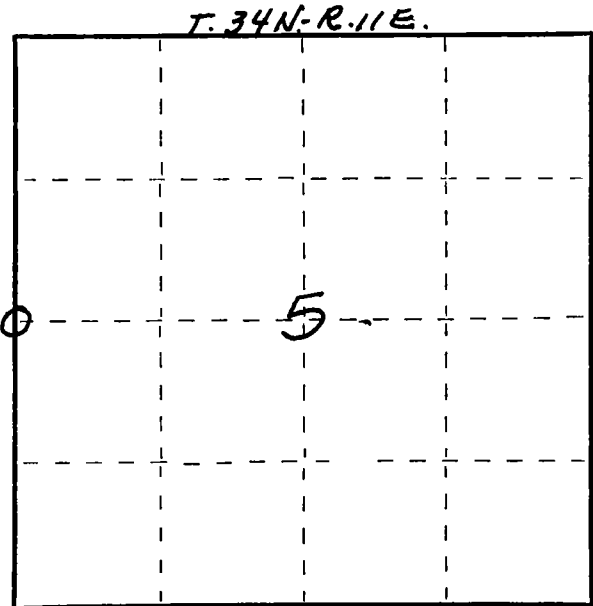

○ = Corner monument restored.

History of original corner establishment:



William F. Kelly

Description of corner evidence found:

FOUND 1 1/2" GALVANIZED I. P. IDENTIFIED BY RESIDENT WITNESSES AS THE W 1/4 COR. SECT. 5, T. 34. N. - R. 11. E.

FOUND EVIDENCE OF OLD WOOD POST IN HOLE WHERE PIPE WAS LOCATED.

Description of monument and accessories I established to perpetuate the original location of this corner.

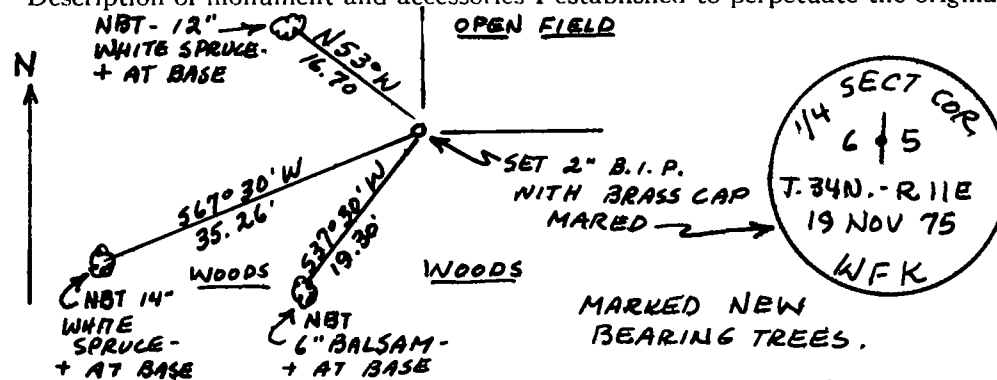

Dated at ELCHO, Wis., this 19th day of NOVEMBER, 1975.

Signature William F. Kelly Title Registered Land Surveyor Registration No. 51098
(County Surveyor, Registered Land Surveyor, or other duly authorized official)

Office of Register of Deeds, County of _____, I hereby certify that the within instrument was filed in this office for record on the _____ day of _____, 19____ at _____ o'clock _____ M.

(Register of Deeds)

By _____ Deputy