

CERTIFIED LAND CORNER RESTORATION

Index No. C-6

State of Wisconsin }
County of Langlade } ss.

I, Philip T. Hansen, do hereby certify that on the 21st day of March, 1980, I ~~found~~ established ~~existence of~~ the WC 1/16 corner of section 5 Township 34, North, Range 11 East, Fourth Principal Meridian, as described hereon; and that from this evidence I established a new monument and accessories as described hereon to perpetuate the original location of this corner.

History of original corner establishment:

Description of corner evidence found:

No records of any corner recovered.
Corner established by traverse and computation. Distance and bearing from W 1/4 to C 1/4 corner is 2959.104 feet at S 86° 55' 38" E.
Set WC 1/16 at 1479.55 feet intermediate.

Resident witnesses:

Glen Barker

Jim Claflin

Herb Wagoner

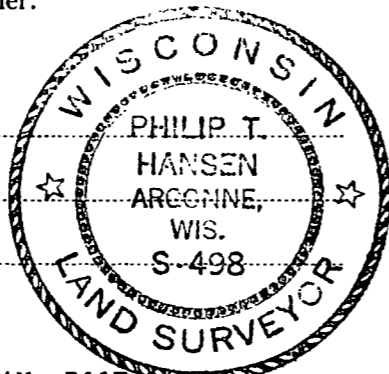

Description of monument and accessories I established to perpetuate the original location of this corner.

Set a 1-1/2" ID iron pipe with screw-on brass cap, stamped:
Monument projects 18" above ground.

Marked NBT's -
Maple 8" N30°W 16.68 feet
Maple 5" S59°E 25.63 feet
both scribed 1/16 BT

T34N R11E
WC 1/16 S⁵
S498 - 1980

FORM 965 H. C. MILLER CO., MILWAUKEE

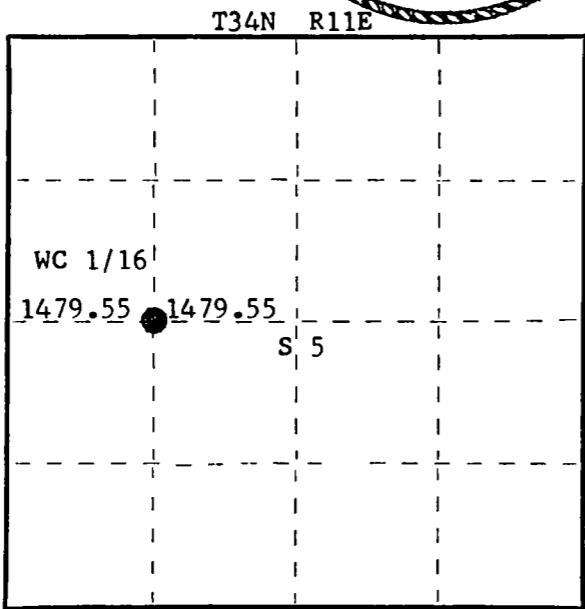

○ = Corner monument restored.

Dated at Rhineland, Wis., this 27th day of March, 1980

Signature: Philip T. Hansen Title: Registered Land Surveyor Registration No. S-498
(County Surveyor, Registered Land Surveyor, or other duly authorized official)

Office of Register of Deeds, County of Langlade, I hereby certify that the within instrument was filed in this office for record on the _____ day of _____, 19____ at _____ o'clock _____ M.

(Register of Deeds)

By _____ Deputy