

CERTIFIED LAND CORNER RESTORATION

Index No. C-7

State of Wisconsin }
 County of Langlade } ss.

I Philip T. Hansen, do hereby certify that on the 26th day of March, 1980, I ~~found~~ established ~~the~~ C 1/4 corner of section 5 Township 34, North, Range 11 East, Fourth Principal Meridian, as described hereon; and that from this evidence I established a new monument and accessories as described hereon to perpetuate the original location of this corner.

Resident witnesses:

Glen Barker

Jim Claflin

Herb Wagoner

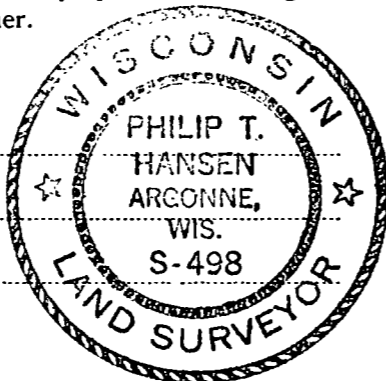

FORM 985 H. C. MILLER CO., MILWAUKEE

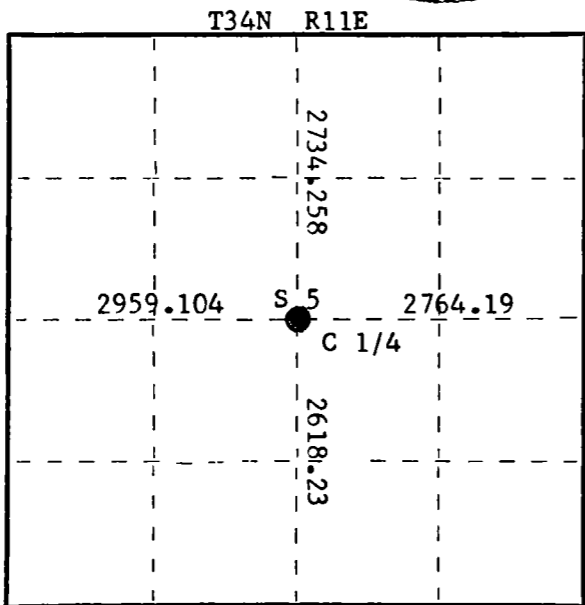

○ = Corner monument restored.

History of original corner establishment:

Description of corner evidence found:

No evidence of any corner recovered. Corner established by traverse and computation. Ran traverse from N 1/4 to S 1/4 and from W 1/4 to E 1/4 to establish corner. Computed distances, 2,734.258', S 3° 41' 43" W of N 1/4 and 2,618.23', N 3° 41' 43" E of S 1/4; 2,764.19', N 86° 55' 38" W of E 1/4 and 2,959.104' S 86° 55' 38" E of W 1/4.

Description of monument and accessories I established to perpetuate the original location of this corner.

Set a 2-1/2" iron pipe with screw on brass cap, stamped:
 Monument projects 16" above ground.

Marked NBT's -
 Maple 9" S23°E 38.50'
 Sugar 5" N9°W 15.40'
 W. Ash 8" N81°W 17.50'
 all scribed C 1/4 BT.

T34N R11E
 C 1/4 S⁵
 S498 - 1980

Dated at Rhineland, Wis., this 7th day of April, 1980

Signature Philip T. Hansen Title Registered Land Surveyor Registration No. S-498
 (County Surveyor, Registered Land Surveyor, or other duly authorized official)

Office of Register of Deeds, County of Langlade, I hereby certify that the within instrument was filed in this office for record on the _____ day of _____, 19____ at _____ o'clock _____ M.

(Register of Deeds)

By _____ Deputy