

CERTIFIED LAND CORNER RESTORATION

Index No. D-6

State of Wisconsin }
County of Langlade } ss.

I, Philip T. Hansen, do hereby certify that on the 16th day of April, 1980, I ~~found~~ established ~~the~~ SW 1/16 corner of Section 5 Township 34, North, Range 11 East, Fourth Principal Meridian, as described hereon; and that from this evidence I established a new monument and accessories as described hereon to perpetuate the original location of this corner.

Resident witnesses:

Glen Barker

Jim Claflin

Herb Wagoner

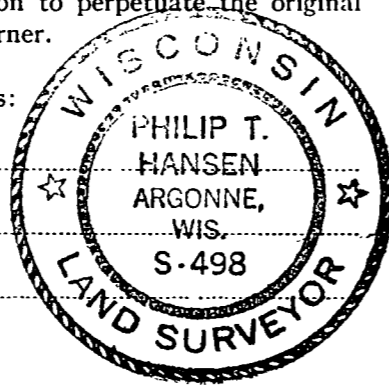

FORM 985 H. C. MILLER CO., MILWAUKEE

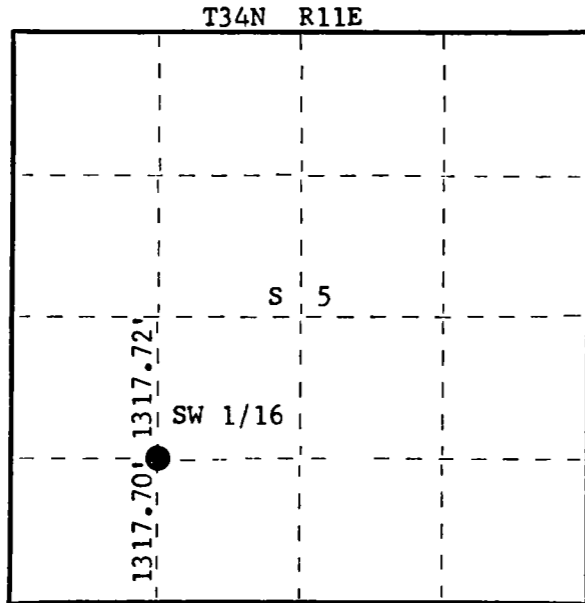

○ = Corner monument restored.

History of original corner establishment:

Description of corner evidence found:

No evidence of any corner recovered. Corner established by traverse and computation. Computed distance from WC 1/16 section 5 to W 1/16 between sections 5 and 8 is 2635.42' at bearing S 5° 15' 10" W. Computed location of SW 1/16 is 1317.72 feet S 5° 15' 10" W of WC 1/16 and 1317.70' N 5° 15' 10" E of W 1/16 between sections 5 and 8. Ran traverse to and set WC 1/16 at 1317.72' from W 1/16 and 1317.70 from WC 1/16.

Description of monument and accessories I established to perpetuate the original location of this corner.

Set a 1-1/2" I.D. iron pipe with screw-on brass cap, stamped:
Monument projects 18" above ground.

Marked NBT's -
Maple 5" S82°W 18.52'
Maple 6" N64°E 55.25'
both scribed 1/16 BT.

T34N R11E
SW 1/16 S⁵
S498 - 1980

Dated at Rhineland, Wis., this 18th day of April, 1980

Signature Philip T. Hansen Title Registered Land Surveyor Registration No. S-498
(County Surveyor, Registered Land Surveyor, or other duly authorized official)

Office of Register of Deeds, County of Langlade, I hereby certify that the within instrument was filed in this office for record on the _____ day of _____, 19____ at _____ o'clock _____ M.

(Register of Deeds)

By _____ Deputy