

CERTIFIED LAND CORNER RESTORATION

Index No. E-8

State of Wisconsin }  
County of Langlade } ss.

I Philip T. Hansen, do hereby certify that on the 9th day of March, 1980, I ~~found~~ established ~~the~~ E 1/16 corner of Sections 5 and 8 Township 34, North, Range 11 East, Fourth Principal Meridian, as described hereon; and that from this evidence I established a new monument and accessories as described hereon to perpetuate the original location of this corner.

Resident witnesses:

Glen Barker

Jim Claflin

Herb Wagoner

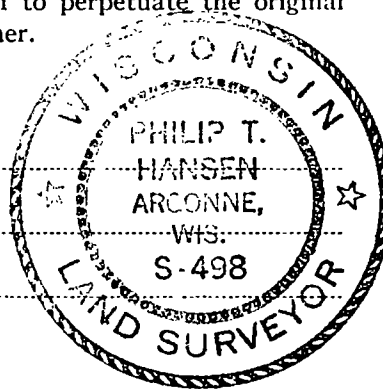

FORM 985 M. C. MILLER CO., MILWAUKEE

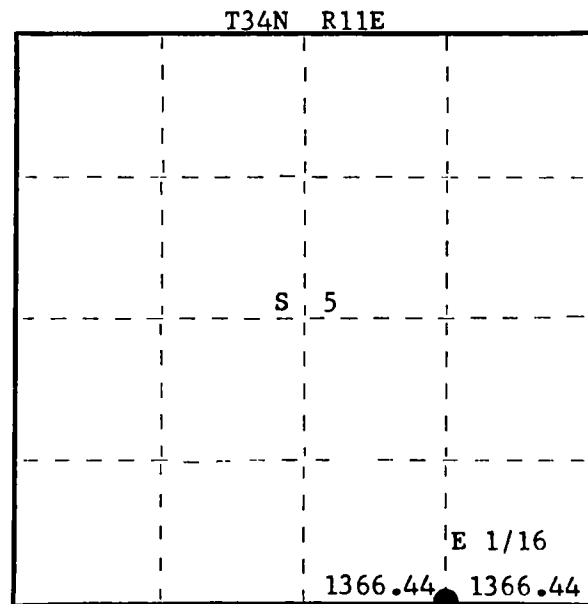

○ = Corner monument restored.

History of original corner establishment:

Description of corner evidence found:

No evidence of any corner recovered. Corner established by traverse and computation. Ran traverse from 1/4 corner between sections 5 and 8 to the section corner 4, 5, 8 and 9. Computed distance is 2732.88 feet at bearing S 87° 14' 43" E. Set E 1/16 at 1366.44 feet intermediate.

Description of monument and accessories I established to perpetuate the original location of this corner.

Set a 1-1/2" I.D. iron pipe with screw-on brass cap, stamped: Monument projects 18" above ground.

Marked NBT's -  
Maple 8" N16°E 10.9 feet  
Maple 8" S46°W 15.95 feet  
both scribed 1/16 BT.

T34N R11E  
E 1/16  $\begin{matrix} S \\ + \\ S \end{matrix} \begin{matrix} 5 \\ 8 \end{matrix}$   
S498 - 1980

Dated at Rhineland, Wis., this 27th day of March, 1980

Signature Philip T. Hansen Title Registered Land Surveyor Registration No. S-498  
(County Surveyor, Registered Land Surveyor, or other duly authorized official)

Office of Register of Deeds, County of Langlade, I hereby certify that the within instrument was filed in this office for record on the \_\_\_\_\_ day of \_\_\_\_\_, 19\_\_\_\_ at \_\_\_\_\_ o'clock \_\_\_\_\_ M.

(Register of Deeds)

By \_\_\_\_\_ Deputy