

CERTIFIED LAND CORNER RESTORATION

34-11
Index No. B-2-17

State of Wisconsin }
County of LANGLADE, } ss.

History of original corner establishment:

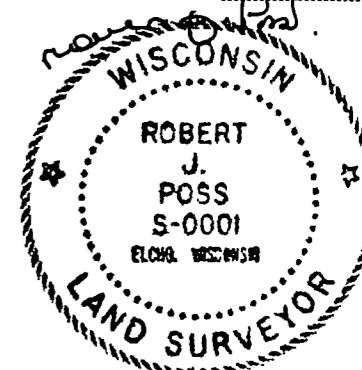

I ROBERT J. POSS, do hereby certify that on the 3RD day of JULY, 1967, I found evidence of the MEANDER corner of SEC. 2 & 3 Township 34, North, Range 11 EAST, Fourth, Principal Meridian, as described hereon; and that from this evidence I established a new monument and accessories as described hereon to perpetuate the original location of this corner.

Description of corner evidence found:

FOUND 2" IRON PIPE SIMILAR TO OTHER STAKES; NO OTHER IDENTIFICATION.

Resident witnesses:

Description of monument and accessories I established to perpetuate the original location of this corner.

SET 1" PIPE WITH 4" BRASS CAP MKED LANGLADE COUNTY
IN 6" X 42" CONCRETE.
TREES NOT BLAZED OR SCRIBED (FRONT YARD)
X₂ = SE COR. MET. BLDG ON CONC. SLAB N78°W 34.5'
X₃ NE COR 1SF RES. S12°W 37.9'; X₄ = NW COR 1-S-F RES S35°W 47.8'
X₅ = N36°W 30.4' TO 24" NWY PINE; X₆ = 10" NWY PINE,
N20°E 11.1' & 12" JACK PINE N21°E 8.0'; X₇ = NWY PINE, 53°W 27.6'

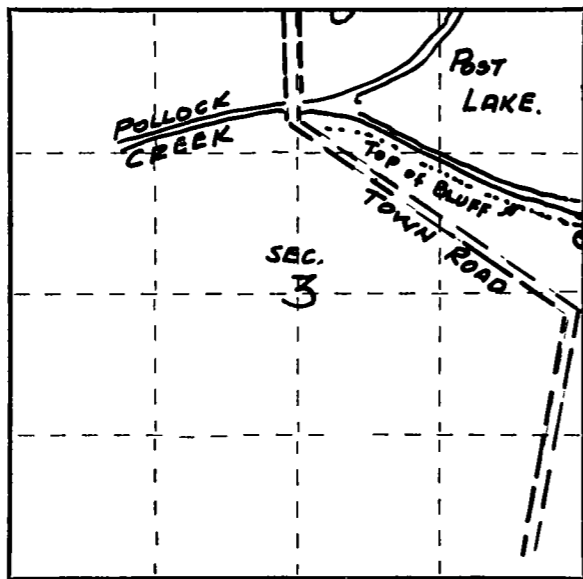
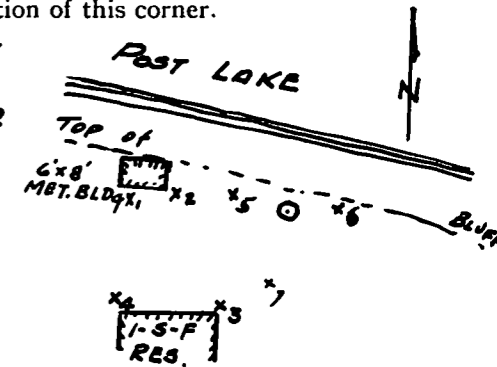

○ = Corner monument restored.

Dated at ELGHO, Wis., this 3RD day of JULY, 1967.

Signature Robert J. Poss Title REG. LAND SURVEYOR Registration No. S-0001
(County Surveyor, Registered Land Surveyor, or other duly authorized official)

Office of Register of Deeds, County of _____, I hereby certify that the within instrument was filed in this office for record on the _____ day of _____, 19____ at _____ o'clock _____ M.

(Register of Deeds)

By _____ Deputy