

CERTIFIED LAND CORNER RESTORATION

34-11

Index No. C-15

State of Wisconsin }
County of LANGLADE } ss.

I ROBERT J. POSS, do hereby certify that on the 1st day of JULY, 1967, I found evidence of the center of sec. corner of 1/4 Post. Township 34, North, Range 11 EAST, Fourth, Principal Meridian, as described hereon; and that from this evidence I established a new monument and accessories as described hereon to perpetuate the original location of this corner.

History of original corner establishment:

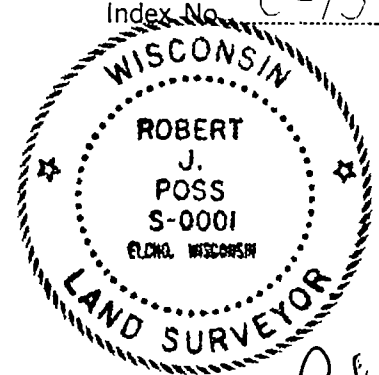

Robert J. Poss

Description of corner evidence found:

**2" IRON PIPE - REMAINS OF WOOD STAKE
18" BELOW GROUND.**

Resident witnesses:

.....
.....
.....

Description of monument and accessories I established to perpetuate the original location of this corner.

**SET 1" IRON PIPE WITH BRASS CAP IN 6"D x 42" CONCRETE.
CAP MKD. LANGLADE COUNTY - T34N R11E CTR. SEC. 3.**

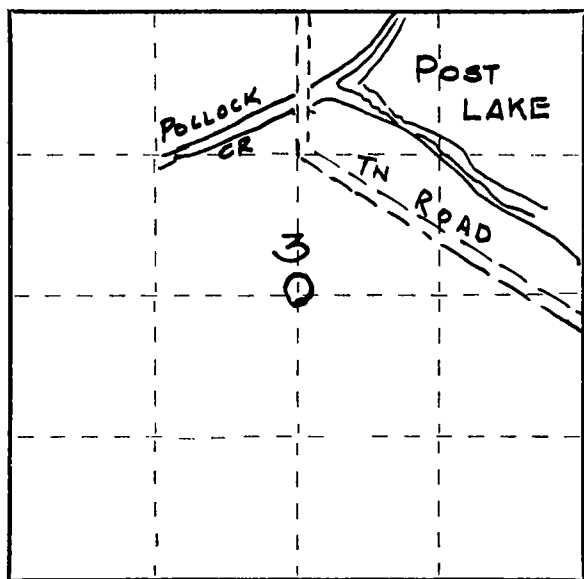

B.T.'s. (BLAZED - NO SCRIBING)

X₁ 6" NWY PINE S68°E 32.3'

X₂ 6" NWY PINE S53°E 31.5'

NO OTHER LARGER TREES NEAR

CULTIVATED

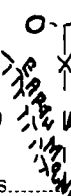

OLD AIR STRIP

Dated at ELCHO, Wis., this 1st day of JULY, 1967.

Signature Robert J. Poss Title REG. LAND SURVEYOR Registration No. S-0001
(County Surveyor, Registered Land Surveyor, or other duly authorized official)

Office of Register of Deeds, County of....., I hereby certify that the within instrument was filed in this office for record on the..... day of....., 19..... at..... o'clock..... M.

.....
(Register of Deeds)

By..... Deputy

○ = Corner monument restored.