

CERTIFIED LAND CORNER RESTORATION

Index No. C-25

34-11

State of Wisconsin }
County of Langlade } ss.

I, Raymond Hallisy, do hereby certify that on the 23rd day of May, 1987, I found evidence of the W 1/4 corner of Section 6 Township 34, North, Range 12 E, Fourth Principal Meridian, as described hereon; and that from this evidence I established a new monument and accessories as described hereon to perpetuate the original location of this corner.

Resident witnesses:

.....
.....
.....

History of original corner establishment:

set by Charlie Borth in 1930, s Resurvey

Description of corner evidence found:

Scribed cedar post Down - Point in ground.
Original BT From 1850, s survey
spruce pine 10" S30E 92 LKs
scrib. marks plain + visible.

Description of monument and accessories I established to perpetuate the original location of this corner.

Set 3" Aluminum pipe w/ cap

New BTs

Red maple 6" N48°W 21.6"
" " 6" N61°E 32'
Red oak 8" S26°E 25'
Red maple 6" S12°W 33'4"

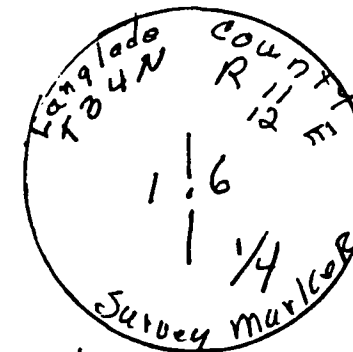

FORM 985 W. C. MILLER CO., MILWAUKEE

T 34 N R 12 E

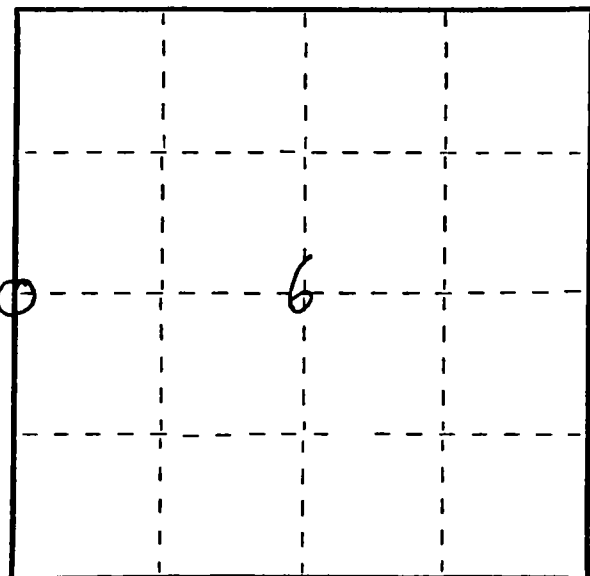

○ = Corner monument restored.

Dated at Antigo, Wis., this 23rd day of MAY, 1987.

Signature Raymond Hallisy Title land surveyor Registration No. 3-685
(County Surveyor, Registered Land Surveyor, or other duly authorized official)

Office of Register of Deeds, County of....., I hereby certify that the within instrument was filed in this office for record on the..... day of....., 19..... at..... o'clock..... M.

(Register of Deeds)

By..... Deputy