

CERTIFIED LAND CORNER RESTORATION

Index No. YY-156

State of Wisconsin }
County of Langlade } ss.

I Daniel K. Pleoger, do hereby certify that on the 25th day of August, 19 80, I ~~restored~~ established ~~the~~ NE 1/16 corner of section 34 Township 34, North, Range 10 East, Fourth Principal Meridian, as described hereon; and that from this evidence I established a new monument and accessories as described hereon to perpetuate the original location of this corner.

Resident witnesses:

.....
.....
.....

FORM 983 K. C. MILLER CO., MILWAUKEE

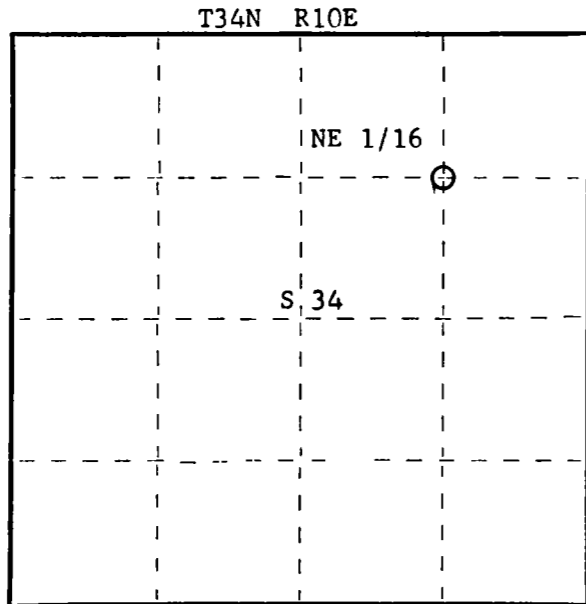

○ = Corner monument restored.

History of original corner establishment:
No evidence of any previous corner.

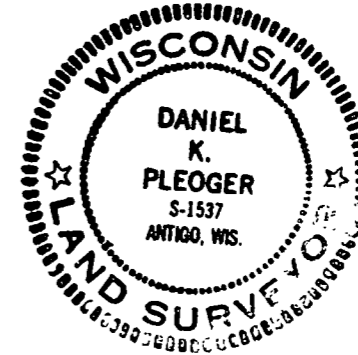

Description of corner evidence found:

Corner established by subdividing the NE 1/4 section 34 T36N R10E. Location of NE 1/16 is S1-18-20E 1362.669 feet of E 1/16 between sections 27 and 34 and N 1-18-20W 1362.668 feet of EC 1/16 section 34.

Description of monument and accessories I established to perpetuate the original location of this corner.

Set a 1-1/2" I.D. iron pipe with screw-on brass cap, stamped:
Monument projects 12" above ground.

Marked NBT's -

- Sugar 7" S74E 4.49 feet
- Sugar 5" S72W 19.96 feet, scribed 1/16 - BT
- Sugar 5" N1E 18.37 feet

Corner sets 6 ft. east of fence, runs south and west

T34N R10E
NE 1/16 ^S+³⁴
S1537-1980

Dated at Rhineland, Wis., this 26th day of November, 19 80

Signature Daniel K. Pleoger Title Registered Land Surveyor Registration No. S-1537
(County Surveyor, Registered Land Surveyor, or other duly authorized official)

Office of Register of Deeds, County of....., I hereby certify that the within instrument was filed in this office for record on the..... day of....., 19..... at..... o'clock..... M.

.....
(Register of Deeds)

By..... Deputy