

CERTIFIED LAND CORNER RESTORATION

Index No. BA-13

33-10

State of Wisconsin }  
County of LANGLADE } ss.

I WILLIAM F. KELLY, do hereby certify that on the 5<sup>th</sup> day of Feb., 1981, I found evidence of the SE corner of SEC. 33 Township 34, North, Range 10 EAST, Fourth Principal Meridian, as described hereon; and that from this evidence I established a new monument and accessories as described hereon to perpetuate the original location of this corner.

Resident witnesses:  
.....  
.....  
.....

History of original corner establishment:  
ORIGINAL CORNER ESTABLISHED  
BY HIRAM C. FELLOWS IN 1860.

Description of corner evidence found:  
FOUND 4" GALVANIZED CAP IN PLACE.  
MONUMENT WAS SET DURING RESURVEY  
OF TOWNSHIP IN 1938.  
LOCATED WITNESS TREES.

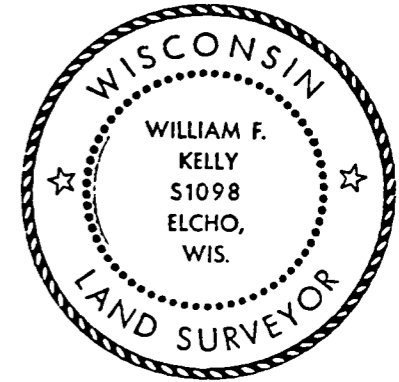

*William F. Kelly*

Description of monument and accessories I established to perpetuate the original location of this corner.

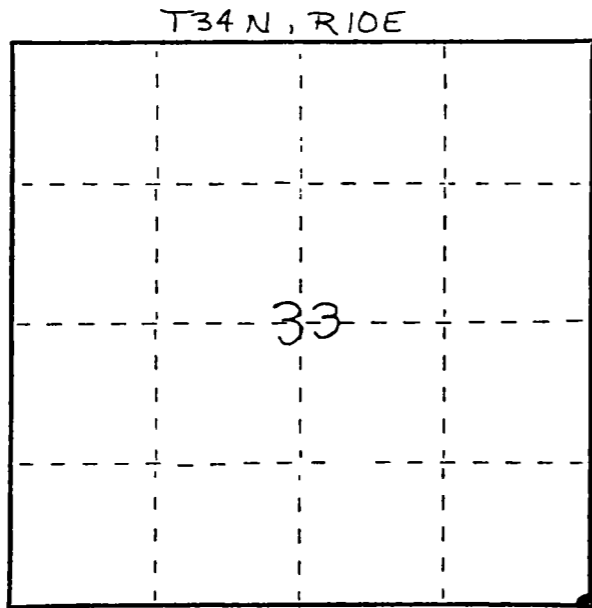
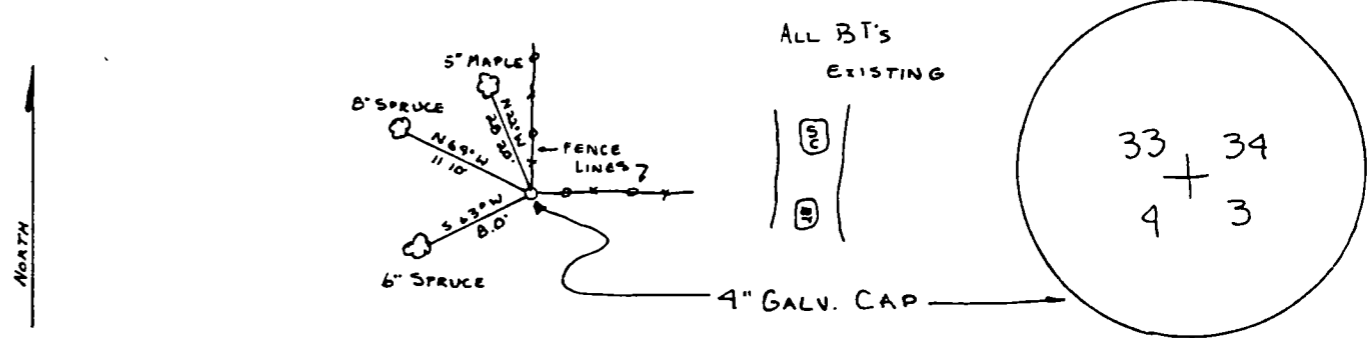

○ = Corner monument restored.

Dated at ELCHO, Wis. this 5<sup>th</sup> day of FEB., 1981.

Signature William F. Kelly Title COUNTY SURVEYOR Registration No. 1098  
(County Surveyor, Registered Land Surveyor, or other duly authorized official)

Office of Register of Deeds, County of ....., I hereby certify that the within instrument was filed in this office for record on the ..... day of ..... 19..... at ..... o'clock ..... M.

(Register of Deeds)

By..... Deputy

FORM 603 W & MILER CO. MILWAUKEE

CERTIFIED LAND CORNER RESTORATION

Index No. 4-13

33-10

State of Wisconsin }  
County of Langlade } ss.

I, Daniel K. Plegger, do hereby certify that on the 17th day of September, 1980, I found evidence of the section corner of sections 33, 34, 4, 3 Township 34 - 33, North, Range 10 East, Fourth Principal Meridian, as described hereon; and that from this evidence I established a new monument and accessories as described hereon to perpetuate the original location of this corner.

Resident witnesses:

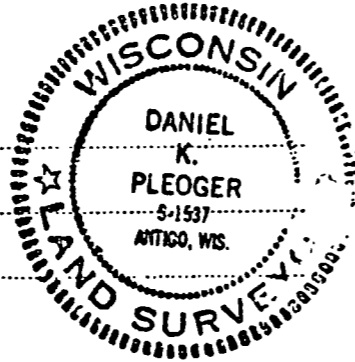

FORM 985 M C MILLER CO. MILWAUKEE

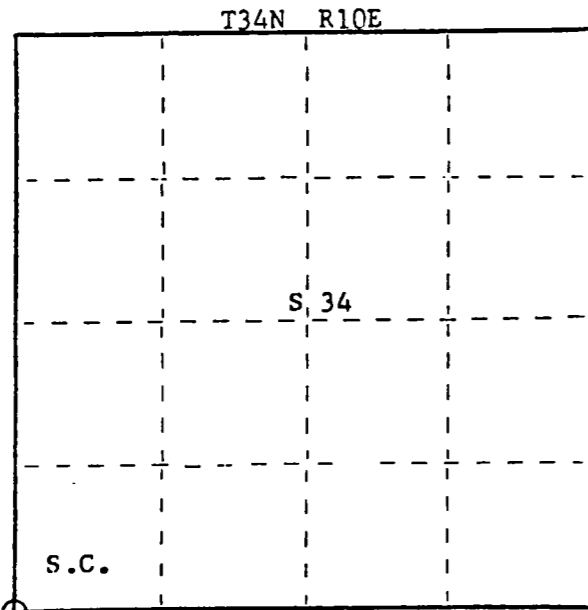

○ = Corner monument restored.

History of original corner establishment:

In 1937 Langlade County surveyors recovered galvanized pipe set by county surveyor from which spruce 5" bears N61-1/2°W 19 links.

Description of corner evidence found:

Recovered a 4" iron pipe with a screw-on iron cap, stamped:  
Monument projects 8" above ground.  
OBT - spruce 5" N61°W, 19.00 links  
down and rotted.

33 + 34  
4 + 3

Description of monument and accessories I established to perpetuate the original location of this corner.

Monument left as recovered.

Marked NBT's -

- Black Spruce 5" S67°W 12.2 links, scribed B.T.
- Black Spruce 7" N61°W 16.9 links, scribed S.C. BT.
- Maple 5" N17°W 42.9 links, scribed S.C. BT.

Dated at Rhinelander, Wis., this 24th day of November, 1980

Signature Daniel K. Plegger Title Registered Land Surveyor Registration No. S-1537  
(County Surveyor, Registered Land Surveyor, or other duly authorized official)

Office of Register of Deeds, County of \_\_\_\_\_, I hereby certify that the within instrument was filed in this office for record on the \_\_\_\_\_ day of \_\_\_\_\_, 19\_\_\_\_ at \_\_\_\_\_ o'clock \_\_\_\_\_ M.

(Register of Deeds)

By \_\_\_\_\_ Deputy