

CERTIFIED LAND CORNER RESTORATION

Index No. XU-9

State of Wisconsin }
County of Langlade } ss.

History of original corner establishment:

No evidence of any previous corner.

I Glen Barker, do hereby certify that on the 31st day of October, 19 83, I ~~found~~ re-established ~~the~~ N 1/16 corner of Sections 32 & 33 Township 34, North, Range 10 East, Fourth Principal Meridian, as described hereon; and that from this evidence I established a new monument and accessories as described hereon to perpetuate the original location of this corner.

Description of corner evidence found:

Total distance from section corner 28-29-32-33 to 1/4 corner between sections 32 & 33 is 2788.36 feet.
Set N 1/16 1394.18 feet intermediate.

Resident witnesses:

J. Claflin, Reg. Land Surveyor
H. Wagoner

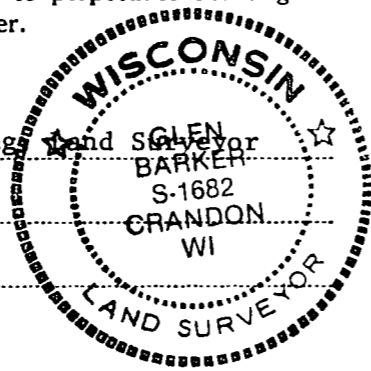

Description of monument and accessories I established to perpetuate the original location of this corner.

Set a 1" iron pipe with 2" diameter alloy cap, stamped:
Monument projects 18" above ground.

Marked NBT's:

Maple 6" N44E 40.75 feet
Maple 9" S45E 40.45 feet
scribed 1/16 - B.T.

S-1682
T34N R10E
N 1/16 32 | 33
CPI-1983

Stock No. 26272
FORM 985

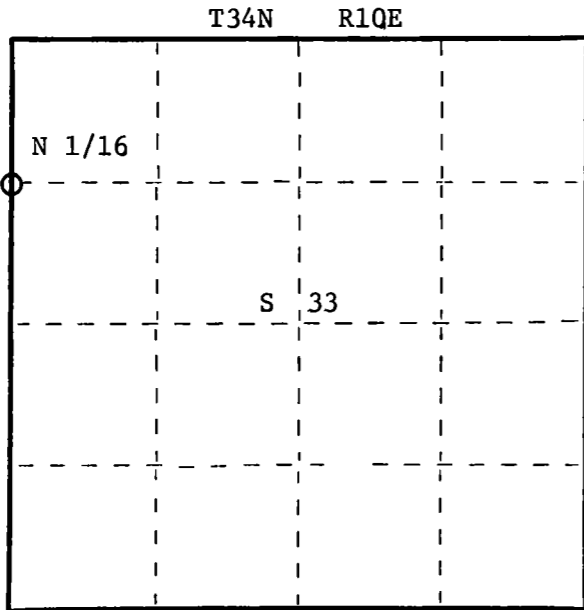

○ = Corner monument restored.

Dated at Rhineland, Wis., this 19th day of December, 19 83

Signature Glen Barker Title Registered Land Surveyor Registration No. S-1682
(County Surveyor, Registered Land Surveyor, or other duly authorized official)

Office of Register of Deeds, County of _____, I hereby certify that the within instrument was filed in this office for record on the _____ day of _____, 19 _____ at _____ o'clock _____ M.

(Register of Deeds)

By _____ Deputy