

CERTIFIED LAND CORNER RESTORATION

Index No. Y-9

State of Wisconsin }
County of LANGLADE } ss.

I WILLIAM F. KELLY, do hereby certify that on the 10th day of APRIL, 1981, I found evidence of the 5/8 corner of Q. M. W. LINE, SEC. 33 Township 34, North, Range 10 EAST, Fourth Principal Meridian, as described hereon; and that from this evidence I established a new monument and accessories as described hereon to perpetuate the original location of this corner.

Resident witnesses:
.....
.....
.....

History of original corner establishment:

ORIGINAL CORNER ESTABLISHED BY JAMES L NOWLIN IN JULY, 1865

Description of corner evidence found:

REPLACED EXISTING 4"x4" WOOD POST WITH 1 1/2" BRASS CAP MONUMENT.

Description of monument and accessories I established to perpetuate the original location of this corner.

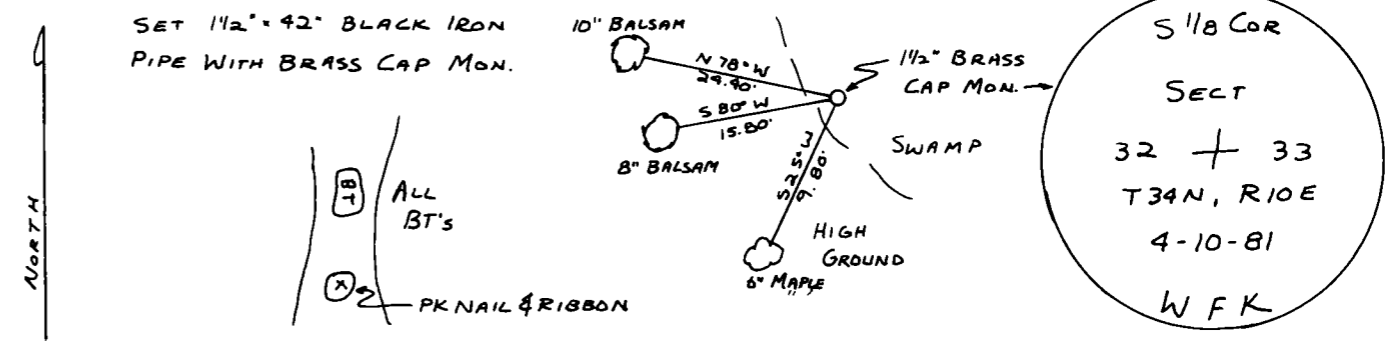

FORM 985 H. C. MILLER CO., MILWAUKEE

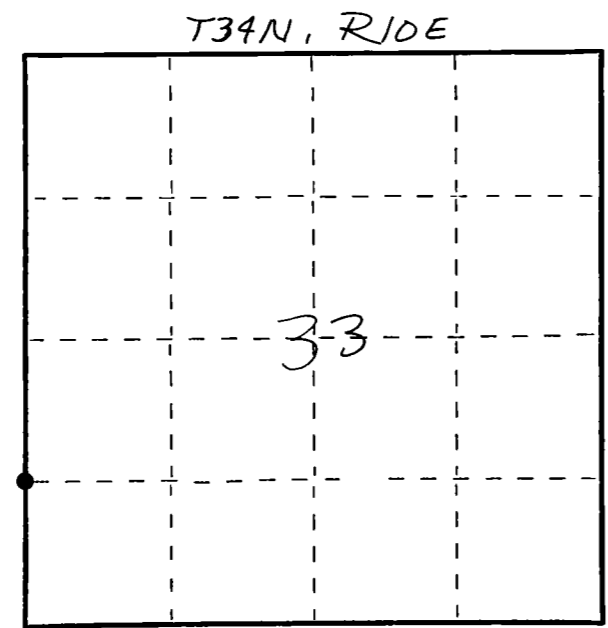

○ = Corner monument restored.

Dated at ELCHO, Wis., this 10th day of APRIL, 1981.

Signature..... Title COUNTY SURVEYOR Registration No. 1098
(County Surveyor, Registered Land Surveyor, or other duly authorized official)

Office of Register of Deeds, County of....., I hereby certify that the within instrument was filed in this office for record on the..... day of....., 19..... at..... o'clock..... M.

.....
(Register of Deeds)

By..... Deputy