

CERTIFIED LAND CORNER RESTORATION

34-10

Index No. 2-8

State of Wisconsin }
County of Lanlade } ss.

I, Raymond J. Hallisy, do hereby certify that on the 25th day of May, 1968, I found evidence of the E 1/16 corner of Section 32 Township 34, North, Range 10, Fourth, Principal Meridian, as described hereon; and that from this evidence I established a new monument and accessories as described hereon to perpetuate the original location of this corner.

Resident witnesses:

.....
.....
.....

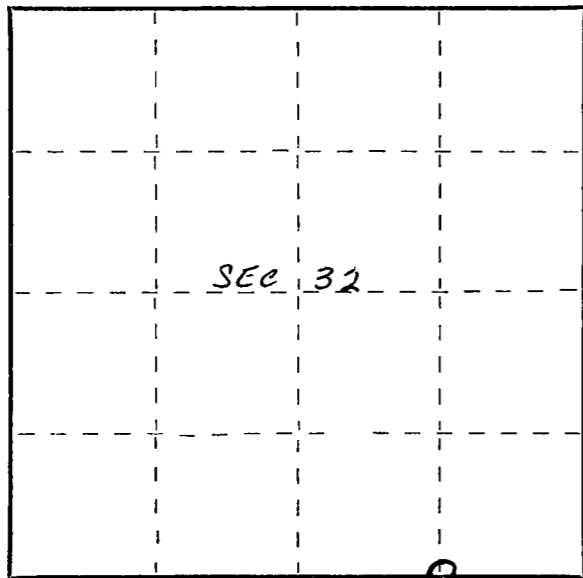

○ = Corner monument restored.

History of original corner establishment:

Corner set in the 1930's by: C. W. Borth
E. F. Kowalke
D. A. Hintz

Description of corner evidence found:

Found squared stake with rock mound
Stake marked E 1/18 S32 S5

Description of monument and accessories I established to perpetuate the original location of this corner.

Set Std. 1 1/2" pipe with cap marked E 1/16 - rock mound

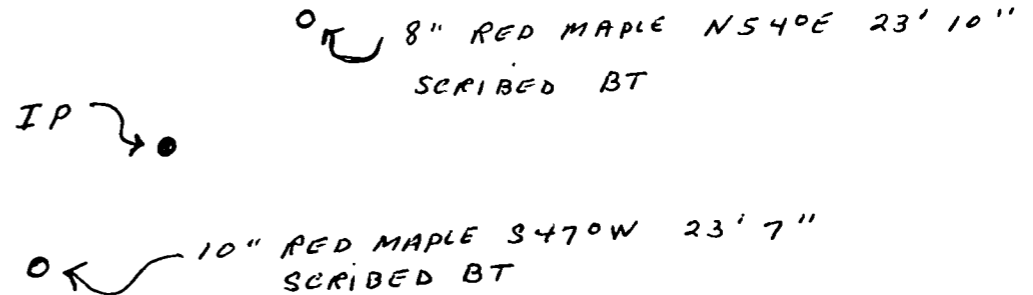

Dated at Antigo, Wis., this 25th day of May, 1968

Signature Raymond J. Hallisy Title Reg. Land Surveyor Registration No. S-685
(County Surveyor, Registered Land Surveyor, or other duly authorized official)

Office of Register of Deeds, County of _____, I hereby certify that the within instrument was filed in this office for record on the _____ day of _____, 19____ at _____ o'clock _____ M.

(Register of Deeds)

By _____ Deputy

FORM 985 H. C. MILLER CO. MILWAUKEE