

CERTIFIED LAND CORNER RESTORATION

Index No. 20-5
34-10

State of Wisconsin }
County of Lincoln } ss.

I, Raymond J. Bellamy, do hereby certify that on the 28th day of July, 1979, I found evidence of the Section corner of 5, 6, 31, & 32 Township 33 & 34, North, Range 10, Fourth Principal Meridian, as described hereon; and that from this evidence I established a new monument and accessories as described hereon to perpetuate the original location of this corner.

Resident witnesses:

.....
.....
.....

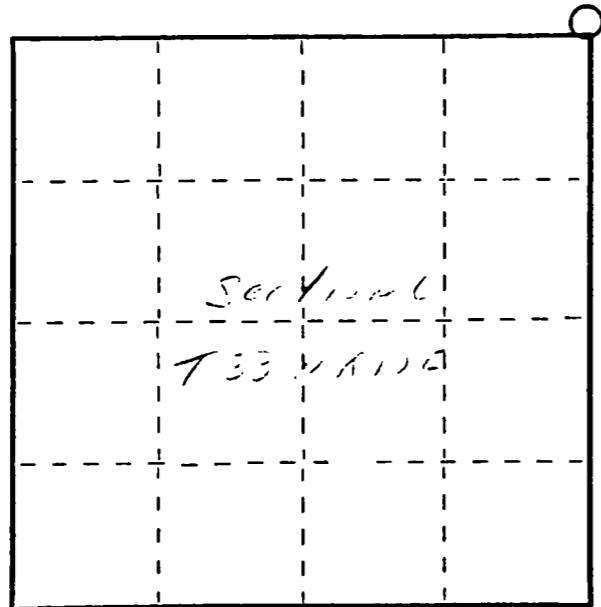

○ = Corner monument restored.

History of original corner establishment:

Corner set in 1830 by county surveyor.

Description of corner evidence found:

1" bl. and red 11"
Large rock with X N50°W 47.5 links
1" Red Marble 11" S60°W 17 links

Description of monument and accessories I established to perpetuate the original location of this corner.

New 11" bl. and red

11" Red Marble N65°E 97.00'
11" Red Marble S22°E 100'
1" Red Marble S16°E 171.50'

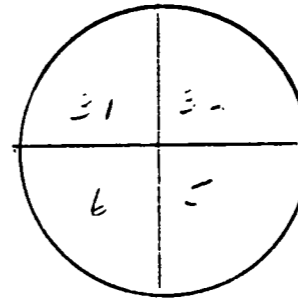

Dated at Lincoln, Wis., this 28th day of July, 1979

Signature Raymond J. Bellamy Title Co. Surveyor Registration No. 5685
(County Surveyor, Register of Deeds, or other authorized official)

Office of Register of Deeds, County of Lincoln, I hereby certify that the within instrument was filed in this office for record on the 28th day of July, 1979 at 10 o'clock AM.

.....
(Register of Deeds)
By..... Deputy

FORM 983 H. C. MILLER CO., MILWAUKEE