

CERTIFIED LAND CORNER RESTORATION

34-10

Index No. U-5

State of Wisconsin }
County of LANGLADE } ss.

I RAYMOND J. HALLISY do hereby certify that on the 28th day of OCTOBER, 1972, I found evidence of the 5 1/16 corner of SECTION 30 Township 34, North, Range 10 EAST, Fourth, Principal Meridian, as described hereon; and that from this evidence I established a new monument and accessories as described hereon to perpetuate the original location of this corner.

Resident witnesses:

.....
.....
.....

History of original corner establishment:

SET IN RESURVEY OF 1930

Description of corner evidence found:

SQUARED STAFF - STANDING
OLD BT
HARD MAPLE 576E 23.2 LINKS

Description of monument and accessories I established to perpetuate the original location of this corner

2 INCH BRASS CAP PIPE IN ROCK MOUND
NEW BT
HARD MAPLE 8" N82W 23 FT, 7 IN,
HARD MAPLE 8" S22W 21 FT, 2 IN,



FORM 985 H. C. MILLER CO., MILWAUKEE

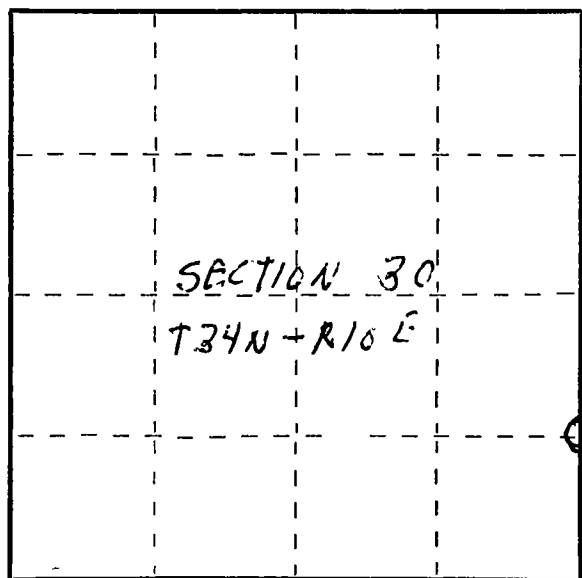

○ = Corner monument restored.

Dated at Antigo, Wis., this 28th day of OCTOBER, 1972

Signature Raymond J. Hallisy Title Reg. Land Surveyor Registration No. 5685
(County Surveyor, Registered Land Surveyor, or other duly authorized official)

Office of Register of Deeds, County of _____, I hereby certify that the within instrument was filed in this office for record on the _____ day of _____, 19____ at _____ o'clock _____ M.

(Register of Deeds)

By _____ Deputy