

CERTIFIED LAND CORNER RESTORATION

Index No. T-14

State of Wisconsin } ss.
County of Langlade

I Daniel K. Pleoger, do hereby certify that on the 14th day of August, 1980, I found and established the W.C. 1/16 corner of section 27 Township 34 North, Range 10 East, Fourth Principal Meridian, as described hereon; and that from this evidence I established a new monument and accessories as described hereon to perpetuate the original location of this corner.

Resident witnesses:

.....
.....
.....

FORM 985 M. C. MILLER CO., MILWAUKEE

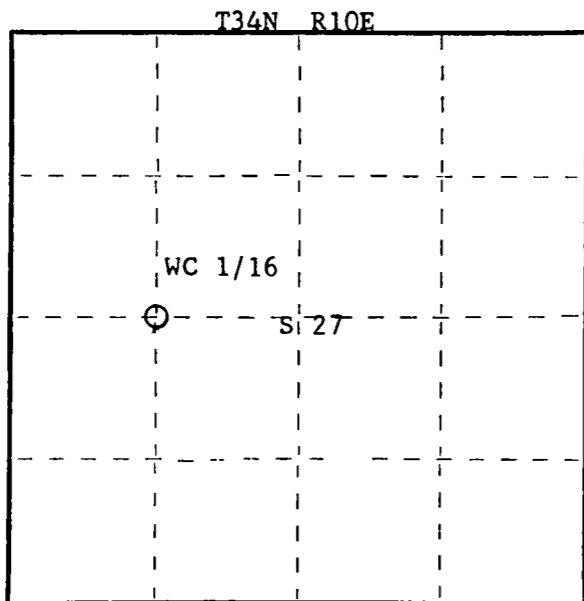

○ = Corner monument restored.

History of original corner establishment:
No evidence of any previous corner.



Description of corner evidence found:

Corner established by proportional measurement.
Computed distance from 1/4 corner between sections 27, 28 to C 1/4 corner section 27 is 2598.873 feet on E-W 1/4 line bearing N89-02-58E. Set W.C. 1/16 1299.436 feet intermediate.

Description of monument and accessories I established to perpetuate the original location of this corner.
Set a 1-1/2" I.D. iron pipe with screw-on brass cap - stamped:
Monument projects 18" above ground.

Marked NBT's -
Maple 6" S68°E 26.50 feet
Hemlock 10" N72°W 45.45 feet
Hemlock 7" S60°W 24.35 feet
scribed 1/16 B.T.

T34N R10E
WC 1/16 S 27
S1537-1980

Dated at Rhinelander, Wis., this 16th day of October, 1980.

Signature Daniel K. Pleoger Title Registered Land Surveyor Registration No. 1537
(County Surveyor, Registered Land Surveyor, or other duly authorized official)

Office of Register of Deeds, County of _____, I hereby certify that the within instrument was filed in this office for record on the _____ day of _____, 19____ at _____ o'clock _____ M.

(Register of Deeds)

By _____ Deputy