

CERTIFIED LAND CORNER RESTORATION

Index No. S-18

State of Wisconsin }  
County of Langlade } ss.

History of original corner establishment:

No evidence of any previous corner.

I Daniel K. Pleoger, do hereby certify that on the 28th day of October, 1980, I established ~~restored~~ the NW 1/16 corner of Section 26 Township 34 North, Range 10 East, Fourth Principal Meridian, as described hereon; and that from this evidence I established a new monument and accessories as described hereon to perpetuate the original location of this corner.

Description of corner evidence found:

Corner established by subdivision of the NW 1/4 section 26. Location of NW 1/16 corner is N88-08-01W 1315.005 feet of NC 1/16 corner and N 0-59-24 E 1323.363 feet of WC 1/16 corner.

Resident witnesses:

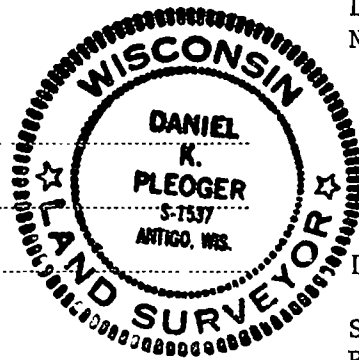

Description of monument and accessories I established to perpetuate the original location of this corner.

Set a 1-1/2" I.D. iron pipe with screw-on brass cap, stamped: Projecting 18" above ground.

Marked NBT's:

- Black Spruce 6" N14°W 24.41 feet
- Black Spruce 6" S66°E 12.00 feet scribed 1/16 B.T.
- Black Spruce 5" S12°E 18.94 feet

T34N R10E  
NW 1/16 S+26  
S1537-1980

FORM 963 H. C. MILLER CO., MILWAUKEE

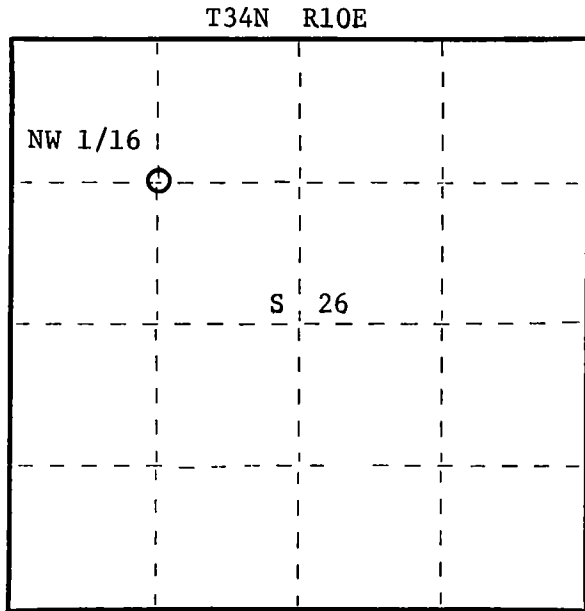

○ = Corner monument restored.

Dated at Rhinelander, Wis., this 23rd day of February, 1981

Signature Daniel K. Pleoger Title Registered Land Surveyor Registration No. 1537  
(County Surveyor/Registered Land Surveyor, or other duly authorized official)

Office of Register of Deeds, County of \_\_\_\_\_, I hereby certify that the within instrument was filed in this office for record on the \_\_\_\_\_ day of \_\_\_\_\_, 19\_\_\_\_ at \_\_\_\_\_ o'clock \_\_\_\_\_ M.

(Register of Deeds)

By \_\_\_\_\_ Deputy